

MATERIAL
OIL DRILL ROD

REV.	DESCRIPTION	DATE	DR.	APVD.
A	ISSUED	04/23/2019	YS	DS

UPPER TOOL (PUNCH) WITH PIN IS DESIGNED TO PROPERLY INSTALL JACK ONTO BOARD

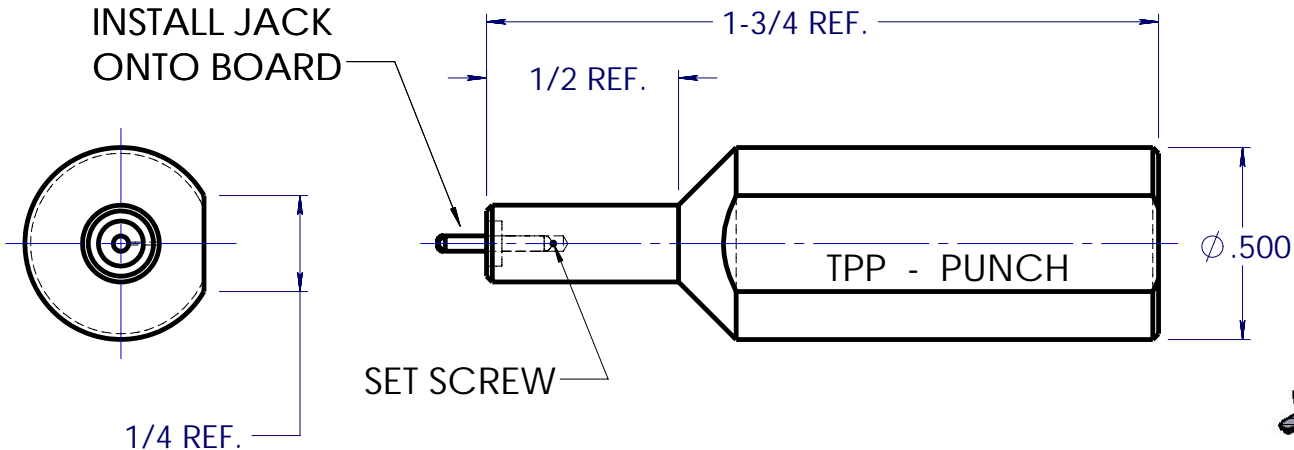

SET SCREW

TPP - PUNCH

Ø.500

1/4 REF.

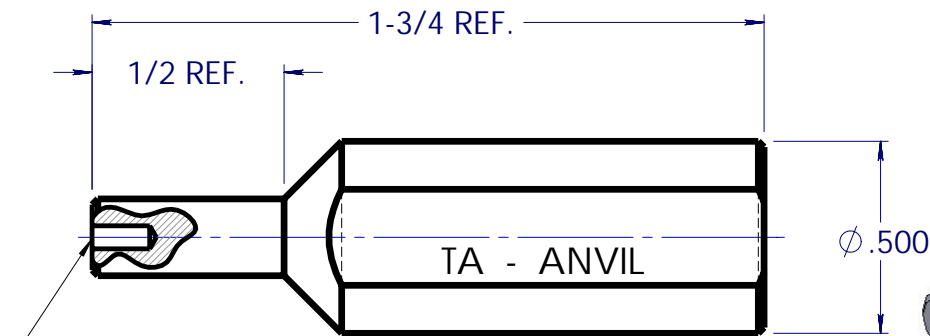

TA - ANVIL

Ø.500

1/4 REF.

LOWER TOOL (ANVIL) IS DESIGNED TO HOLD JACK IN PROPER POSITION DURING INSTALLATION OPERATION

UNLESS OTHERWISE SPECIFIED:

DIMENSIONS ARE IN INCHES

TOLERANCES:

THREE PLACE DECIMAL ±0.010
FRACTIONAL ±1/64

PROPRIETARY AND CONFIDENTIAL

THE INFORMATION CONTAINED IN THIS DRAWING IS THE SOLE PROPERTY OF CONCORD ELECTRONICS INC. ANY REPRODUCTION IN PART OR AS A WHOLE WITHOUT THE WRITTEN PERMISSION OF CONCORD ELECTRONIC INC. IS PROHIBITED.



TITLE:
GENERIC DRAWING OF INSTALLATION TOOLS FOR PRESS FIT (TA & TPP TYPES), ARBOR PRESS OPERATED

DWG. NO.

TA & TPP

REV

A



PAGE: 1 OF 2

SCALE: NTS

REV.	DESCRIPTION	DATE	DR.	APVD.
A	ISSUED	04/23/2019	YS	DS

PRESS FIT INSTALLATION PROCEDURES FOR JACKS

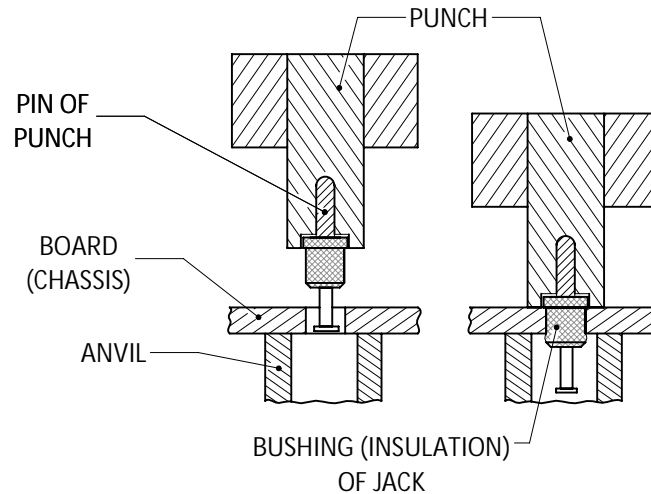

PRESS FIT FOR INSULATED JACKS:

1. DRILL THROUGH-HOLE AND COUNTERSINK BOARD ACCORDING TO BOARD THICKNESS (SEE INDIVIDUAL PART SPECIFICATIONS FOR RECOMMENDED HOLE SIZE).
2. PLACE PROPER CONCORD'S ANVIL AND PUNCH INTO ARBOR PRESS AND ALIGN TOOLS PRIOR INSERTION FORCE.
3. CENTER CHASSIS HOLE AND PUNCH WITH A JACK.
4. PRESS JACK INTO BOARD HOLE UNTIL SHOULDER OF BUSHING IS FULLY SEATED AGAINST BOARD. PRESSURE BY INSERTION TOOL ON JACK WILL LOCKS INSULATION BY EXPANDING OUTSIDE DIAMETER OF BUSHING AND REDUCING DIAMETER OF BUSHING HOLE.
5. RAISE THE PUNCH TOOL FROM INSTALLED JACK WHICH IS NOW PERMANENTLY IN PLACE.

UNLESS OTHERWISE SPECIFIED:

DIMENSIONS ARE IN INCHES

TOLERANCES:

THREE PLACE DECIMAL ± 0.010
 FRACTIONAL $\pm 1/64$

PROPRIETARY AND CONFIDENTIAL

THE INFORMATION CONTAINED IN THIS DRAWING IS THE SOLE PROPERTY OF CONCORD ELECTRONICS INC. ANY REPRODUCTION IN PART OR AS A WHOLE WITHOUT THE WRITTEN PERMISSION OF CONCORD ELECTRONIC INC. IS PROHIBITED.



TITLE:
 GENERIC DRAWING OF INSTALLATION TOOLS FOR PRESS FIT (TA & TPP TYPES), ARBOR PRESS OPERATED

DWG. NO.

TA & TPP

REV

A



PAGE: 2 OF 2

SCALE: NTS