

<b>DRAWING NUMBER:</b>	<b>10-703-X-XX</b>
<b>PRODUCT GROUP:</b>	TERMINALS
<b>SUB-GROUP:</b>	COMMERCIAL NON-INSULATED TERMINALS
<b>DESCRIPTION:</b>	NON-INSULATED THREAD MOUNT TURRET TERMINAL

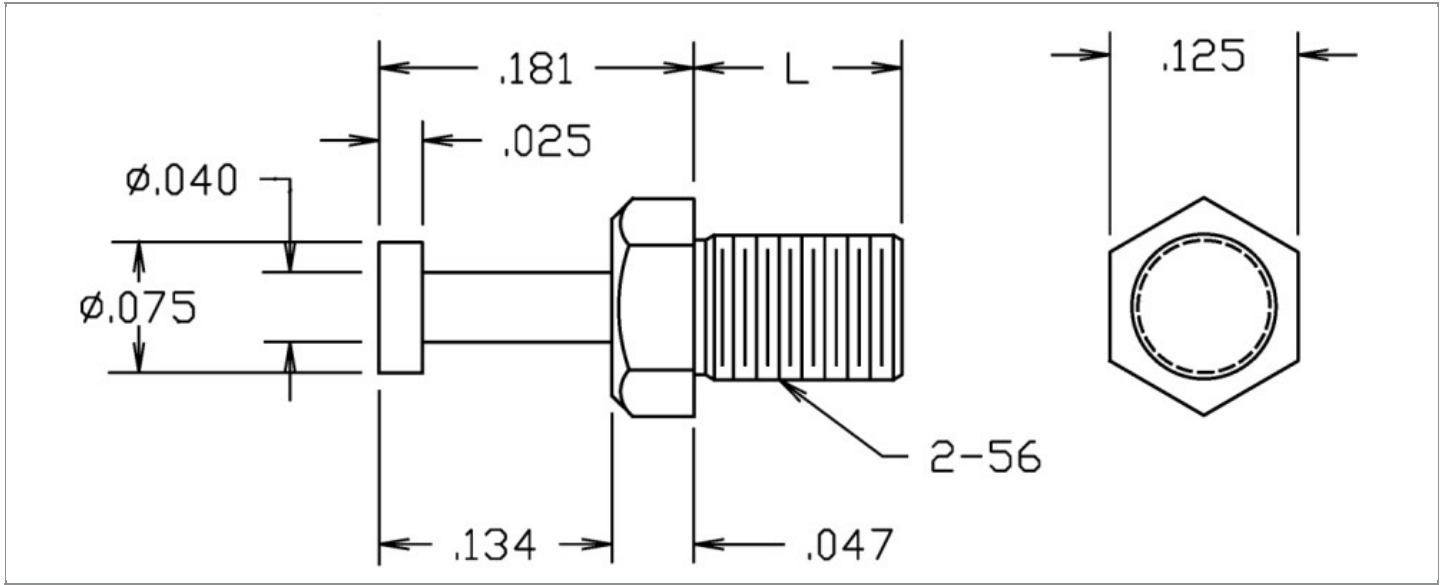

BOARD / PANEL MOUNTING METHOD	MOUNTING HOLE SIZE	DRILL SIZE	FEED THRU COMBINATION
THREAD MOUNT (2-56)	2-56 THREAD	N/A	N/A

**PART NO. STRUCTURE:**

10-703 - X - XX  
 PART SERIES    DIMENSION    FINISH

**MATERIAL OPTIONS:**

10-703-X-XX

COMPONENT	MATERIAL	MATERIAL AND SPECIFICATION
TERMINAL	BRASS	BRASS PER ASTM B16, ALLOY C36000, 1/2 HARD

**DIMENSION OPTIONS:**

10-703-X-XX

DIMENSION	A	D	PIN DIAMETER	OVERALL LENGTH	SHANK LENGTH (L)	BOARD/PANEL THICKNESS
2	N/A	0.062"	N/A	0.244"	N/A	N/A
3	N/A	0.094"	N/A	0.274"	N/A	N/A
4	N/A	0.125"	N/A	0.306"	N/A	N/A
6	N/A	0.187"	N/A	0.368"	N/A	N/A
8	N/A	0.250"	N/A	0.431"	N/A	N/A
10	N/A	0.312"	N/A	0.494"	N/A	N/A

FINISH - PLATING OPTIONS:

10-703-X-XX

FINISH CODE	COMPONENT	FINISH	FINISH AND SPECIFICATION
01	TERMINAL	SILVER	0.000300"MIN. SILVER PER ASTM B700, TYPE 2, GRADE D WITH A NON-CHROMATE PRESERVATIVE TREATMENT
03	TERMINAL	GOLD	0.000010"MIN. GOLD PER ASTM B488, TYPE II, CODE C OVER 0.000050"MIN. NICKEL PER SAE-AMS-QQ-N-290
035	TERMINAL	GOLD	0.000050"MIN. GOLD PER ASTM B488, TYPE II, CODE C OVER 0.000050"MIN. NICKEL PER SAE-AMS-QQ-N-290
04	TERMINAL	ELECTRO-TIN	0.000300"MIN. ELECTRO-TIN PER ASTM B545 OVER 0.000100"MIN. COPPER PER SAE-AMS-2418
044	TERMINAL	BRIGHT ELECTRO-TIN	0.000300"MIN. BRIGHT ELECTRO-TIN PER ASTM B545 OVER 0.000100"MIN. COPPER PER SAE-AMS-2418
05	TERMINAL	ELECTRO-SOLDER	0.000300"MIN. ELECTRO-SOLDER PER SAE-AMS-P-81728 OVER 0.000100"MIN. COPPER PER SAE-AMS-2418
088	TERMINAL	BRIGHT TIN-LEAD	0.000300"MIN. BRIGHT TIN-LEAD (Sn93%-Pb7%) PER ASTM B545 OVER 0.000100"MIN. COPPER PER SAE-AMS-2418

TOLERANCES:\*

DECIMAL	FRACTIONAL	ANGULAR	DRAWING ORIGATION DATE	LAST MODIFICATION DATE
± 0.005	± 1/64	± 5 °	10/14/1997	3/1/2017

\*All dimensions are in inches.

RoHS COMPLIANCE:

10-703-2-XX

PART NUMBER	RoHS COMPLIANT
10-703-2-01	YES
10-703-2-03	YES
10-703-2-035	YES
10-703-2-04	YES
10-703-2-044	YES
10-703-2-05	NO
10-703-2-088	NO

10-703-3-XX

PART NUMBER	RoHS COMPLIANT
10-703-3-01	YES
10-703-3-03	YES
10-703-3-035	YES
10-703-3-04	YES
10-703-3-044	YES
10-703-3-05	NO
10-703-3-088	NO

10-703-4-XX

PART NUMBER	RoHS COMPLIANT
10-703-4-01	YES
10-703-4-03	YES
10-703-4-035	YES
10-703-4-04	YES
10-703-4-044	YES
10-703-4-05	NO
10-703-4-088	NO

Continued on next page...

RoHS COMPLIANCE CONTINUED:

10-703-6-XX

PART NUMBER	RoHS COMPLIANT
10-703-6-01	YES
10-703-6-03	YES
10-703-6-035	YES
10-703-6-04	YES
10-703-6-044	YES
10-703-6-05	NO
10-703-6-088	NO

10-703-8-XX

PART NUMBER	RoHS COMPLIANT
10-703-8-01	YES
10-703-8-03	YES
10-703-8-035	YES
10-703-8-04	YES
10-703-8-044	YES
10-703-8-05	NO
10-703-8-088	NO

10-703-10-XX

PART NUMBER	RoHS COMPLIANT
10-703-10-01	YES
10-703-10-03	YES
10-703-10-035	YES
10-703-10-04	YES
10-703-10-044	YES
10-703-10-05	NO
10-703-10-088	NO

TOOLING:

INSTALLATION TOOL: ARBOR PRESS	INSTALLATION TOOL: ANVIL (ARBOR PRESS OPERATED)	INSTALLATION TOOL: PRESS-FIT / ROLL SWAGE / RIVET PUNCH (ARBOR PRESS OPERATED)	INSTALLATION TOOL: FLARE SWAGE PUNCH (ARBOR PRESS OPERATED)
N/A	N/A	N/A	N/A

NOTES:

<b>DATASHEET NOTES</b>
------------------------

N/A

<b>INSTRUCTION NOTES</b>
--------------------------

N/A