

DRAWING NUMBER:	09-2101-1-XXXX
PRODUCT GROUP:	TERMINALS
SUB-GROUP:	COMMERCIAL INSULATED TERMINALS
DESCRIPTION:	PTFE INSULATED THRU-HOLE DOUBLE TURRET TERMINAL

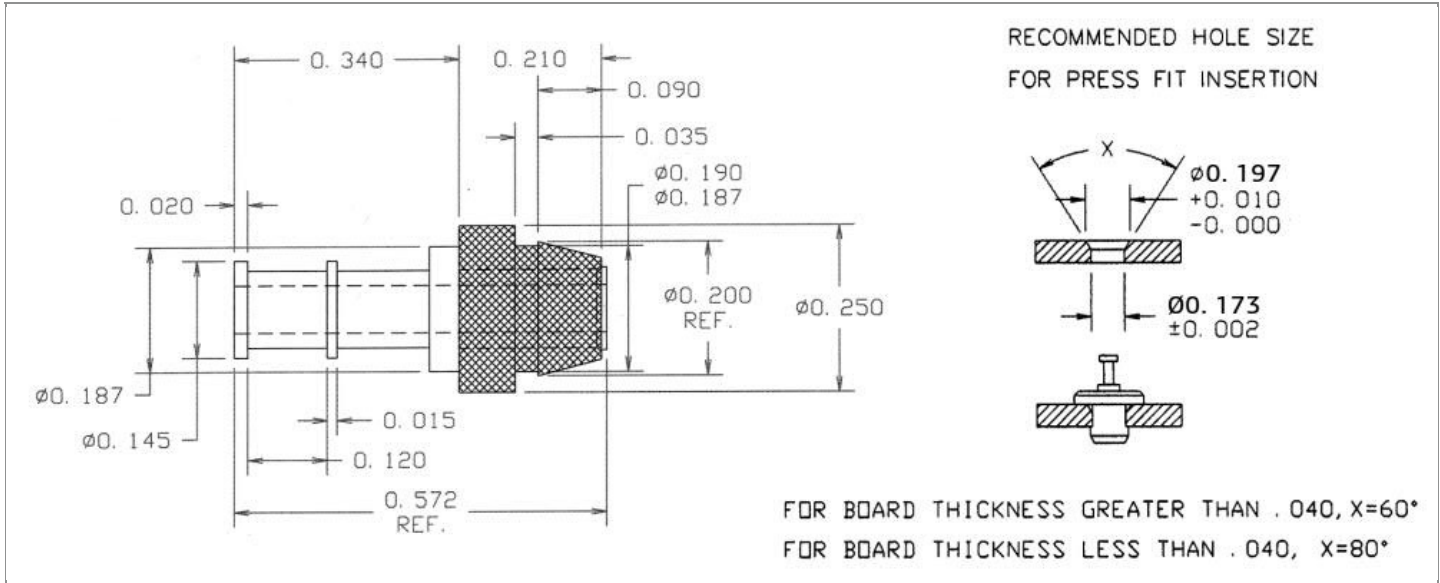

OVERALL LENGTH	PIN DIAMETER	FEED THRU COMBINATION	BOARD / PANEL MOUNTING METHOD
0.572"	N/A	N/A	PRESS LOCK

SHANK LENGTH (L)	BOARD / PANEL THICKNESS	MOUNTING HOLE SIZE	DRILL SIZE
N/A	1/32" - 1/16"	0.173" ± 0.002	#17

PART NO. STRUCTURE:

09-2101	-	1	-	XX	XX
PART SERIES		DIMENSION		FINISH	INSULATION COLOR

MATERIAL OPTIONS:

09-2101-1-XXXX

COMPONENT	MATERIAL	MATERIAL AND SPECIFICATION
TERMINAL	BRASS	BRASS PER ASTM B16, ALLOY C36000, 1/2 HARD
BASE/METAL SLEEVE	N/A	N/A
INSULATION*	PTFE	PTFE PER ASTM D1710
NUT	N/A	N/A
WASHER	N/A	N/A

*For Insulation color, please see INSULATION COLOR OPTIONS on Page 3

FINISH - PLATING OPTIONS:

09-2101-1-XXXX

FINISH CODE	COMPONENT	FINISH	FINISH AND SPECIFICATION
01	TERMINAL	SILVER	0.000300"MIN. SILVER PER ASTM B700, TYPE 2, GRADE D WITH A NON-CHROMATE PRESERVATIVE TREATMENT
	BASE/METAL SLEEVE	N/A	N/A
	NUT	N/A	N/A
	WASHER	N/A	N/A
03	TERMINAL	GOLD	0.00010"MIN. GOLD PER ASTM B488, TYPE II, CODE C OVER 0.000100"MIN. NICKEL PER SAE-AMS-QQ-N-290
	BASE/METAL SLEEVE	N/A	N/A
	NUT	N/A	N/A
	WASHER	N/A	N/A
04	TERMINAL	ELECTRO-TIN	0.000300"MIN. ELECTRO-TIN PER ASTM B545 OVER 0.000100"MIN. NICKEL PER SAE-AMS-QQ-N-290
	BASE/METAL SLEEVE	N/A	N/A
	NUT	N/A	N/A
	WASHER	N/A	N/A
044	TERMINAL	BRIGHT ELECTRO-TIN	0.000300"MIN. BRIGHT ELECTRO-TIN PER ASTM B545 OVER 0.000100"MIN. NICKEL PER SAE-AMS-QQ-N-290
	BASE/METAL SLEEVE	N/A	N/A
	NUT	N/A	N/A
	WASHER	N/A	N/A
05	TERMINAL	ELECTRO-SOLDER	0.000300"MIN. ELECTRO-SOLDER PER SAE-AMS-P-81728 OVER 0.000100"MIN. NICKEL PER SAE-AMS-QQ-N-290
	BASE/METAL SLEEVE	N/A	N/A
	NUT	N/A	N/A
	WASHER	N/A	N/A
088	TERMINAL	BRIGHT TIN-LEAD	0.000300"MIN. BRIGHT TIN-LEAD (Sn93%-Pb7%) PER ASTM B545 OVER 0.000100"MIN. NICKEL PER SAE-AMS-QQ-N-290
	BASE/METAL SLEEVE	N/A	N/A
	NUT	N/A	N/A
	WASHER	N/A	N/A

INSULATION COLOR OPTIONS:

09-2101-1-XX **XX**

INSULATION COLOR	BLACK	BLUE	BROWN	GRAY	GREEN	ORANGE	RED	VIOLET	WHITE	YELLOW
COLOR CODE NO.	10	16	11	18	15	13	12	17	19	14

TOLERANCES:*

DECIMAL	FRACTIONAL	ANGULAR	DRAWING ORIGATION DATE	LAST MODIFICATION DATE
± 0.005	± 0.010	± 5 °	1/4/2000	3/1/2017

*All dimensions are in inches.

RoHS COMPLIANCE:

09-2101-1-01XX

PART NUMBER	RoHS COMPLIANT
09-2101-1-0110	YES
09-2101-1-0111	NO
09-2101-1-0112	NO
09-2101-1-0113	NO
09-2101-1-0114	NO
09-2101-1-0115	YES
09-2101-1-0116	YES
09-2101-1-0117	YES
09-2101-1-0118	NO
09-2101-1-0119	YES

09-2101-1-03XX

PART NUMBER	RoHS COMPLIANT
09-2101-1-0310	YES
09-2101-1-0311	NO
09-2101-1-0312	NO
09-2101-1-0313	NO
09-2101-1-0314	NO
09-2101-1-0315	YES
09-2101-1-0316	YES
09-2101-1-0317	YES
09-2101-1-0318	NO
09-2101-1-0319	YES

09-2101-1-04XX

PART NUMBER	RoHS COMPLIANT
09-2101-1-0410	YES
09-2101-1-0411	NO
09-2101-1-0412	NO
09-2101-1-0413	NO
09-2101-1-0414	NO
09-2101-1-0415	YES
09-2101-1-0416	YES
09-2101-1-0417	YES
09-2101-1-0418	NO
09-2101-1-0419	YES

09-2101-1-044XX

PART NUMBER	RoHS COMPLIANT
09-2101-1-04410	YES
09-2101-1-04411	NO
09-2101-1-04412	NO
09-2101-1-04413	NO
09-2101-1-04414	NO
09-2101-1-04415	YES
09-2101-1-04416	YES
09-2101-1-04417	YES
09-2101-1-04418	NO
09-2101-1-04419	YES

09-2101-1-05XX

PART NUMBER	RoHS COMPLIANT
09-2101-1-0510	NO
09-2101-1-0511	NO
09-2101-1-0512	NO
09-2101-1-0513	NO
09-2101-1-0514	NO
09-2101-1-0515	NO
09-2101-1-0516	NO
09-2101-1-0517	NO
09-2101-1-0518	NO
09-2101-1-0519	NO

09-2101-1-088XX

PART NUMBER	RoHS COMPLIANT
09-2101-1-08810	NO
09-2101-1-08811	NO
09-2101-1-08812	NO
09-2101-1-08813	NO
09-2101-1-08814	NO
09-2101-1-08815	NO
09-2101-1-08816	NO
09-2101-1-08817	NO
09-2101-1-08818	NO
09-2101-1-08819	NO

TOOLING:

INSTALLATION TOOL: ARBOR PRESS	INSTALLATION TOOL: ANVIL (ARBOR PRESS OPERATED)	INSTALLATION TOOL: PRESS-FIT / ROLL SWAGE / RIVET PUNCH (ARBOR PRESS OPERATED)	INSTALLATION TOOL: PRESS-FIT (HAND OPERATED)
TM1	TA09-2101	TPI09-2101	TTI09-2101

NOTES:

DATASHEET NOTES

PIN TERMINAL AND BUSHING (INSULATION) SUPPLIED UNASSEMBLED.

INSTRUCTION NOTES

THIS PTFE INSULATED TERMINAL PROVIDES AN EXTRA SECURE MOUNTING ONTO THE BOARD OR CHASSIS. TO INSTALL, FIRST THE BUSHING IS INSERTED INTO THE MOUNTING HOLE. THE TERMINAL IS THEN PRESSED INTO THE BUSHING TO THE DRAWING DIMENSIONS. THE DIAMETER OF THE PTFE BUSHING THAT EXTENDS PAST THE BACK SIDE OF THE BOARD EXPANDS TO ANCHOR THE PIN/BUSHING ASSEMBLY IN PLACE. SEE GENERAL PRESS LOCK INSTALLATION INSTRUCTION ON CONCORD ELECTRONICS' WEBSITE WWW.CONCORD-ELECTRONICS.COM.