

DRAWING NUMBER:	09-0210-X-XX
PRODUCT GROUP:	TERMINALS
SUB-GROUP:	COMMERCIAL NON-INSULATED TERMINALS
DESCRIPTION:	NON-INSULATED THREAD MOUNT SLOTTED TERMINAL

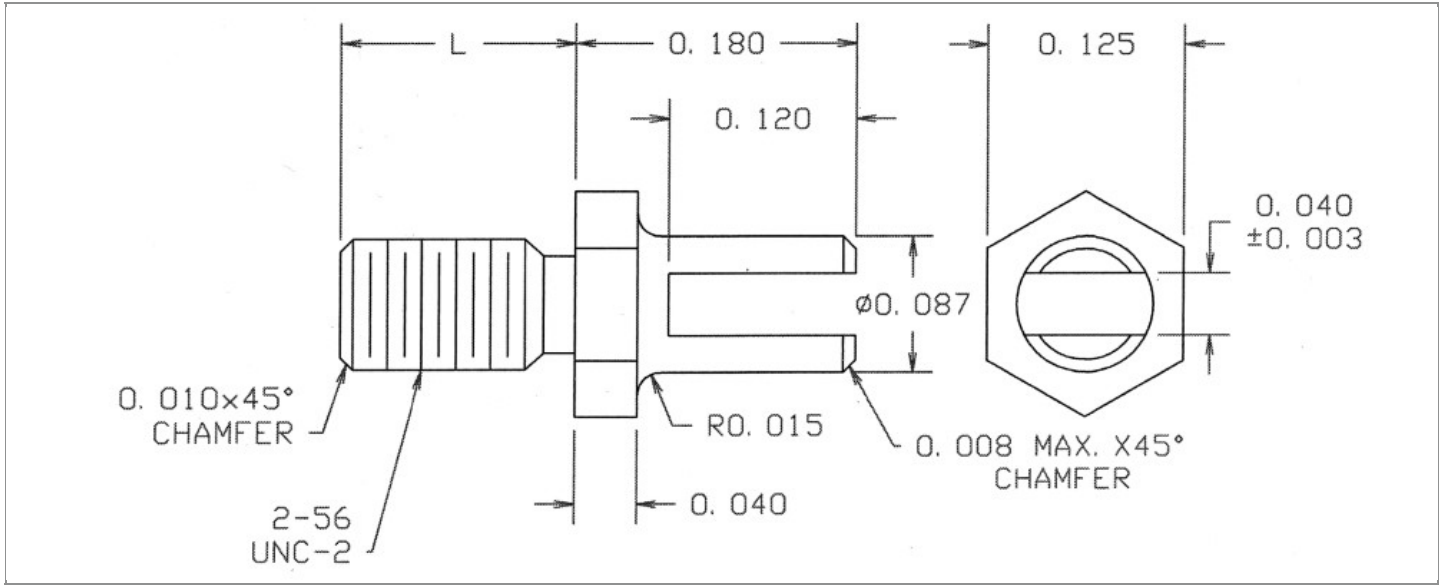

BOARD / PANEL MOUNTING METHOD	MOUNTING HOLE SIZE	DRILL SIZE	FEED THRU COMBINATION
THREAD MOUNT (2-56)	2-56 THREAD	N/A	N/A

PART NO. STRUCTURE:

09-0210 - X - XX
 PART SERIES DIMENSION FINISH

MATERIAL OPTIONS:

09-0210-X-XX

COMPONENT	MATERIAL	MATERIAL AND SPECIFICATION
TERMINAL	BRASS	BRASS PER ASTM B16, ALLOY C36000, 1/2 HARD

DIMENSION OPTIONS:

09-0210-X-XX

DIMENSION	A	D	PIN DIAMETER	OVERALL LENGTH	SHANK LENGTH (L)	BOARD/PANEL THICKNESS
5	N/A	0.150"	N/A	0.330"	N/A	N/A
6	N/A	0.080"	N/A	0.260"	N/A	N/A
7	N/A	0.187"	N/A	0.367"	N/A	N/A
8	N/A	0.220"	N/A	0.400"	N/A	N/A

FINISH - PLATING OPTIONS:

09-0210-X-**XX**

FINISH CODE	COMPONENT	FINISH	FINISH AND SPECIFICATION
01	TERMINAL	SILVER	0.000300"MIN. SILVER PER ASTM B700, TYPE 2, GRADE D WITH A NON-CHROMATE PRESERVATIVE TREATMENT
03	TERMINAL	GOLD	0.000010"MIN. GOLD PER ASTM B488, TYPE II, CODE C OVER 0.000050"MIN. NICKEL PER SAE-AMS-QQ-N-290
035	TERMINAL	GOLD	0.000050"MIN. GOLD PER ASTM B488, TYPE II, CODE C OVER 0.000050"MIN. NICKEL PER SAE-AMS-QQ-N-290
04	TERMINAL	ELECTRO-TIN	0.000300"MIN. ELECTRO-TIN PER ASTM B545 OVER 0.000100"MIN. COPPER PER SAE-AMS-2418
044	TERMINAL	BRIGHT ELECTRO-TIN	0.000300"MIN. BRIGHT ELECTRO-TIN PER ASTM B545 OVER 0.000100"MIN. COPPER PER SAE-AMS-2418
05	TERMINAL	ELECTRO-SOLDER	0.000300"MIN. ELECTRO-SOLDER PER SAE-AMS-P-81728 OVER 0.000100"MIN. COPPER PER SAE-AMS-2418
088	TERMINAL	BRIGHT TIN-LEAD	0.000300"MIN. BRIGHT TIN-LEAD (Sn93%-Pb7%) PER ASTM B545 OVER 0.000100"MIN. COPPER PER SAE-AMS-2418
095	TERMINAL	HOT SOLDER DIP	0.000100"MIN. HOT SOLDER DIP USING Sn60 PER IPC-J-STD-006 OVER 0.000100"MIN. COPPER PER SAE-AMS-2418

TOLERANCES:*

DECIMAL	FRACTIONAL	ANGULAR	DRAWING ORIGATION DATE	LAST MODIFICATION DATE
± 0.005	± 1/64	± 5 °	12/4/2002	3/1/2017

*All dimensions are in inches.

RoHS COMPLIANCE:

09-0210-5-XX

PART NUMBER	RoHS COMPLIANT
09-0210-5-01	YES
09-0210-5-03	YES
09-0210-5-035	YES
09-0210-5-04	YES
09-0210-5-044	YES
09-0210-5-05	NO
09-0210-5-088	NO
09-0210-5-095	NO

09-0210-6-XX

PART NUMBER	RoHS COMPLIANT
09-0210-6-01	YES
09-0210-6-03	YES
09-0210-6-035	YES
09-0210-6-04	YES
09-0210-6-044	YES
09-0210-6-05	NO
09-0210-6-088	NO
09-0210-6-095	NO

09-0210-7-XX

PART NUMBER	RoHS COMPLIANT
09-0210-7-01	YES
09-0210-7-03	YES
09-0210-7-035	YES
09-0210-7-04	YES
09-0210-7-044	YES
09-0210-7-05	NO
09-0210-7-088	NO
09-0210-7-095	NO

Continued on next page...

RoHS COMPLIANCE CONTINUED:

09-0210-8-XX

PART NUMBER	RoHS COMPLIANT
09-0210-8-01	YES
09-0210-8-03	YES
09-0210-8-035	YES
09-0210-8-04	YES
09-0210-8-044	YES
09-0210-8-05	NO
09-0210-8-088	NO
09-0210-8-095	NO

TOOLING:

INSTALLATION TOOL: ARBOR PRESS	INSTALLATION TOOL: ANVIL (ARBOR PRESS OPERATED)	INSTALLATION TOOL: PRESS-FIT / ROLL SWAGE / RIVET PUNCH (ARBOR PRESS OPERATED)	INSTALLATION TOOL: FLARE SWAGE PUNCH (ARBOR PRESS OPERATED)
N/A	N/A	N/A	N/A

NOTES:

DATASHEET NOTES
N/A
INSTRUCTION NOTES
N/A