

DRAWING NUMBER:	1169-36M-XXXX
PRODUCT GROUP:	TERMINALS
SUB-GROUP:	MILITARY INSULATED TERMINALS
DESCRIPTION:	DIALLYL PHTHALATE INSULATED DOUBLE TURRET TERMINAL

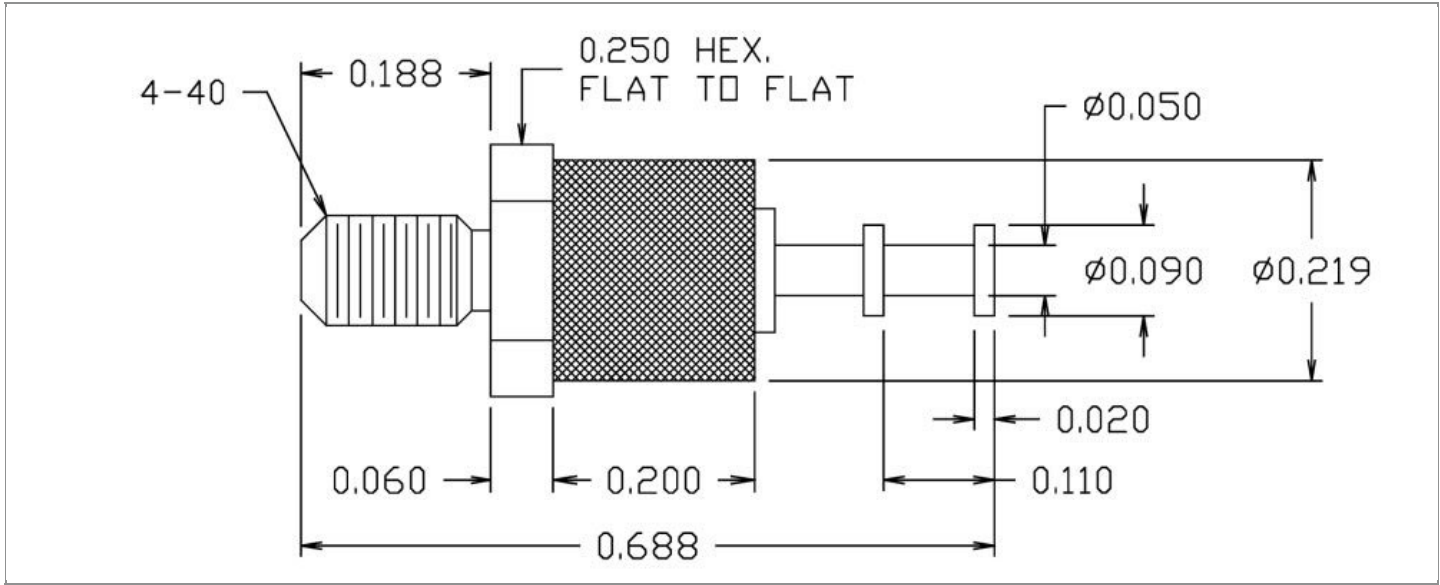

PIN DIAMETER	OVERALL LENGTH	MOUNTING ORIENTATION	BOARD / PANEL MOUNTING METHOD
N/A	0.688"	VERTICAL	THREAD MOUNT (4-40 NUT)
BOARD / PANEL THICKNESS	MOUNTING HOLE SIZE	DRILL SIZE	FEED THRU COMBINATION
UP TO 5/64"	0.120" ± 0.002	#31	N/A

PART NO. STRUCTURE:*

1169	-	36M	-	XX		XX
PART SERIES		DIMENSION		FINISH		INSULATION COLOR

*If applicable, "Z" at the end of a PART NO. STRUCTURE indicates TERMINAL MATERIAL TYPE.

MATERIAL OPTIONS:

1169-36M-XXXX

COMPONENT	MATERIAL	MATERIAL AND SPECIFICATION
TERMINAL	BRASS	BRASS PER ASTM B16, ALLOY C36000, 1/2 HARD
BASE/METAL SLEEVE	BRASS	BRASS PER ASTM B16, ALLOY C36000, 1/2 HARD
INSULATION*	DIALLYL PHTHALATE	MOLDED DIALLYL PHTHALATE, TYPE SDG-F PER ASTM D5948
NUT	BRASS	BRASS PER ASTM B16, ALLOY C36000, 1/2 HARD
WASHER	PHOSPHOR BRONZE	PHOSPHOR BRONZE PER MS35333

*For Insulation color, please see INSULATION COLOR OPTIONS on Page 2

FINISH - PLATING OPTIONS:

1169-36M-XXXX

FINISH CODE	COMPONENT	FINISH	FINISH AND SPECIFICATION
05	TERMINAL	ELECTRO-SOLDER	0.000300"MIN. ELECTRO-SOLDER PER SAE-AMS-P-81728 OVER 0.000100"MIN. COPPER PER SAE-AMS-2418
	BASE/METAL SLEEVE	ELECTRO-SOLDER	0.000100"MIN. ELECTRO-SOLDER PER SAE-AMS-P-81728 OVER 0.000100"MIN. NICKEL PER SAE-AMS-QQ-N-290
	NUT	NICKEL	0.000100"MIN. NICKEL PER SAE-AMS-QQ-N-290
	WASHER	NICKEL	0.000100"MIN. NICKEL PER SAE-AMS-QQ-N-290
088	TERMINAL	BRIGHT TIN-LEAD	0.000300"MIN. BRIGHT TIN-LEAD (Sn93%-Pb7%) PER ASTM B545 OVER 0.000100"MIN. COPPER PER SAE-AMS-2418
	BASE/METAL SLEEVE	BRIGHT TIN-LEAD	0.000100"MIN. BRIGHT TIN-LEAD (Sn93%-Pb7%) PER ASTM B545 OVER 0.000100"MIN. NICKEL PER SAE-AMS-QQ-N-290
	NUT	NICKEL	0.000100"MIN. NICKEL PER SAE-AMS-QQ-N-290
	WASHER	NICKEL	0.000100"MIN. NICKEL PER SAE-AMS-QQ-N-290
095	TERMINAL	HOT SOLDER DIP	0.000100"MIN. HOT SOLDER DIP USING Sn60 PER IPC-J-STD-006 OVER 0.000100"MIN. COPPER PER SAE-AMS-2418
	BASE/METAL SLEEVE	BRIGHT TIN-LEAD	0.000100"MIN. BRIGHT TIN-LEAD (Sn93%-Pb7%) PER ASTM B545 OVER 0.000100"MIN. NICKEL PER SAE-AMS-QQ-N-290
	NUT	NICKEL	0.000100"MIN. NICKEL PER SAE-AMS-QQ-N-290
	WASHER	NICKEL	0.000100"MIN. NICKEL PER SAE-AMS-QQ-N-290

INSULATION COLOR OPTIONS:

1169-36M-XXXX

INSULATION COLOR	BLACK	BLUE	BROWN	GRAY	GREEN	ORANGE	RED	VIOLET	WHITE	YELLOW
COLOR CODE NO.	10	16	11	18	15	13	12	17	19	14

TOLERANCES:*

DECIMAL	FRACTIONAL	ANGULAR	DRAWING ORIGATION DATE	LAST MODIFICATION DATE
± 0.015	N/A	N/A	6/24/1996	3/1/2017

*All dimensions are in inches.

RoHS COMPLIANCE:

1169-36M-05XX

PART NUMBER	RoHS COMPLIANT
1169-36M-0510	NO
1169-36M-0511	NO
1169-36M-0512	NO
1169-36M-0513	NO
1169-36M-0514	NO
1169-36M-0515	NO
1169-36M-0516	NO
1169-36M-0517	NO
1169-36M-0518	NO
1169-36M-0519	NO

1169-36M-088XX

PART NUMBER	RoHS COMPLIANT
1169-36M-08810	NO
1169-36M-08811	NO
1169-36M-08812	NO
1169-36M-08813	NO
1169-36M-08814	NO
1169-36M-08815	NO
1169-36M-08816	NO
1169-36M-08817	NO
1169-36M-08818	NO
1169-36M-08819	NO

1169-36M-095XX

PART NUMBER	RoHS COMPLIANT
1169-36M-09510	NO
1169-36M-09511	NO
1169-36M-09512	NO
1169-36M-09513	NO
1169-36M-09514	NO
1169-36M-09515	NO
1169-36M-09516	NO
1169-36M-09517	NO
1169-36M-09518	NO
1169-36M-09519	NO

MILITARY REFERENCE SPECIFICATIONS:

1169-36M-05XX

PART NUMBER	MIL SPECIFICATION	MIL PART NUMBER	COMMERCIAL ITEM DESCRIPTION (CID) SPECIFICATION	CID PART NUMBER
1169-36M-0510	MIL-T-55155/09	M55155/090H03 (SE090E03S)	A-A-59126/09	AA59126/090H03
1169-36M-0511	MIL-T-55155/09	M55155/091H03 (SE091E03S)	A-A-59126/09	AA59126/091H03
1169-36M-0512	MIL-T-55155/09	M55155/092H03 (SE092E03S)	A-A-59126/09	AA59126/092H03
1169-36M-0513	MIL-T-55155/09	M55155/093H03 (SE093E03S)	A-A-59126/09	AA59126/093H03
1169-36M-0514	MIL-T-55155/09	M55155/094H03 (SE094E03S)	A-A-59126/09	AA59126/094H03
1169-36M-0515	MIL-T-55155/09	M55155/095H03 (SE095E03S)	A-A-59126/09	AA59126/095H03
1169-36M-0516	MIL-T-55155/09	M55155/096H03 (SE096E03S)	A-A-59126/09	AA59126/096H03
1169-36M-0517	MIL-T-55155/09	M55155/097H03 (SE097E03S)	A-A-59126/09	AA59126/097H03
1169-36M-0518	MIL-T-55155/09	M55155/098H03 (SE098E03S)	A-A-59126/09	AA59126/098H03
1169-36M-0519	MIL-T-55155/09	M55155/099H03 (SE099E03S)	A-A-59126/09	AA59126/099H03

1169-36M-088XX

PART NUMBER	MIL SPECIFICATION	MIL PART NUMBER	COMMERCIAL ITEM DESCRIPTION (CID) SPECIFICATION	CID PART NUMBER
1169-36M-08810	MIL-T-55155/09	M55155/090J03	A-A-59126/09	AA59126/090J03 (AA59126/09003)
1169-36M-08811	MIL-T-55155/09	M55155/091J03	A-A-59126/09	AA59126/091J03 (AA59126/09103)
1169-36M-08812	MIL-T-55155/09	M55155/092J03	A-A-59126/09	AA59126/092J03 (AA59126/09203)
1169-36M-08813	MIL-T-55155/09	M55155/093J03	A-A-59126/09	AA59126/093J03 (AA59126/09303)
1169-36M-08814	MIL-T-55155/09	M55155/094J03	A-A-59126/09	AA59126/094J03 (AA59126/09403)

Continued on next page...

MILITARY REFERENCE SPECIFICATIONS CONTINUED:

1169-36M-088XX

PART NUMBER	MIL SPECIFICATION	MIL PART NUMBER	COMMERCIAL ITEM DESCRIPTION (CID) SPECIFICATION	CID PART NUMBER
1169-36M-08815	MIL-T-55155/09	M55155/095J03	A-A-59126/09	AA59126/095J03 (AA59126/09503)
1169-36M-08816	MIL-T-55155/09	M55155/096J03	A-A-59126/09	AA59126/096J03 (AA59126/09603)
1169-36M-08817	MIL-T-55155/09	M55155/097J03	A-A-59126/09	AA59126/097J03 (AA59126/09703)
1169-36M-08818	MIL-T-55155/09	M55155/098J03	A-A-59126/09	AA59126/098J03 (AA59126/09803)
1169-36M-08819	MIL-T-55155/09	M55155/099J03	A-A-59126/09	AA59126/099J03 (AA59126/09903)

1169-36M-095XX

PART NUMBER	MIL SPECIFICATION	MIL PART NUMBER	COMMERCIAL ITEM DESCRIPTION (CID) SPECIFICATION	CID PART NUMBER
1169-36M-09510	MIL-T-55155/09	M55155/090I03	A-A-59126/09	AA59126/090I03
1169-36M-09511	MIL-T-55155/09	M55155/091I03	A-A-59126/09	AA59126/091I03
1169-36M-09512	MIL-T-55155/09	M55155/092I03	A-A-59126/09	AA59126/092I03
1169-36M-09513	MIL-T-55155/09	M55155/093I03	A-A-59126/09	AA59126/093I03
1169-36M-09514	MIL-T-55155/09	M55155/094I03	A-A-59126/09	AA59126/094I03
1169-36M-09515	MIL-T-55155/09	M55155/095I03	A-A-59126/09	AA59126/095I03
1169-36M-09516	MIL-T-55155/09	M55155/096I03	A-A-59126/09	AA59126/096I03
1169-36M-09517	MIL-T-55155/09	M55155/097I03	A-A-59126/09	AA59126/097I03
1169-36M-09518	MIL-T-55155/09	M55155/098I03	A-A-59126/09	AA59126/098I03
1169-36M-09519	MIL-T-55155/09	M55155/099I03	A-A-59126/09	AA59126/099I03

TOOLING:

INSTALLATION TOOL: ARBOR PRESS	INSTALLATION TOOL: ANVIL (ARBOR PRESS OPERATED)	INSTALLATION TOOL: PRESS-FIT / ROLL SWAGE / RIVET PUNCH (ARBOR PRESS OPERATED)	INSTALLATION TOOL: PRESS-FIT (HAND OPERATED)
N/A	N/A	N/A	N/A

NOTES:

DATASHEET NOTES

NUT PART NO.: 701-7317-02, WASHER PART NO.: 701-7723-02.

INSTRUCTION NOTES

SUPPLIED WITH NICKEL PLATED BRASS HEX NUT (4-40 x 1/4" x 3/32") AND NICKEL PLATED PHOSPHOR BRONZE #4 INTERNAL TOOTH LOCKWASHER.