

DRAWING NUMBER:	1133-01M-XXXX
PRODUCT GROUP:	TERMINALS
SUB-GROUP:	MILITARY INSULATED TERMINALS
DESCRIPTION:	PTFE INSULATED FEED THRU (DOUBLE TURRET/PIN) TERMINAL

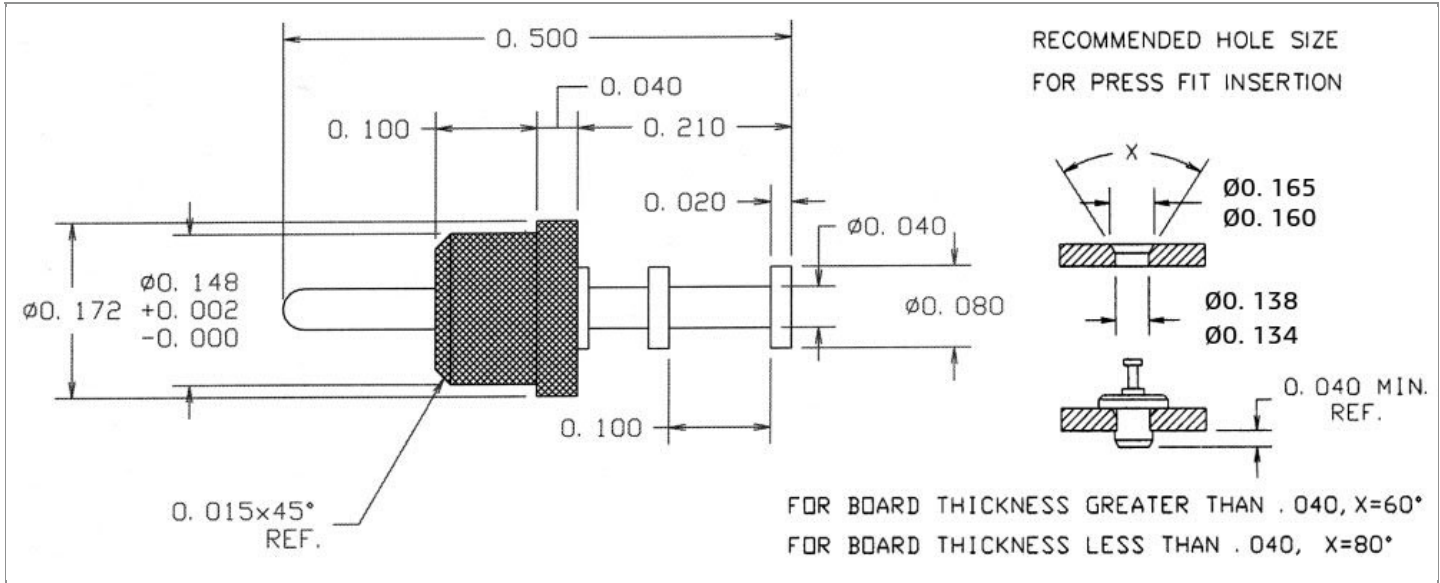

PIN DIAMETER	OVERALL LENGTH	MOUNTING ORIENTATION	BOARD / PANEL MOUNTING METHOD
0.040" ± 0.005	0.500"	VERTICAL	PRESS FIT

BOARD / PANEL THICKNESS	MOUNTING HOLE SIZE	DRILL SIZE	FEED THRU COMBINATION
UP TO 1/16"	0.136" ± 0.002	#29	DOUBLE TURRET/PIN

PART NO. STRUCTURE:*

1133	-	01M	-	XX	XX
PART SERIES		DIMENSION		FINISH	INSULATION COLOR

*If applicable, "Z" at the end of a PART NO. STRUCTURE indicates TERMINAL MATERIAL TYPE.

MATERIAL OPTIONS:

1133-01M-XXXX

COMPONENT	MATERIAL	MATERIAL AND SPECIFICATION
TERMINAL	BRASS	BRASS PER ASTM B16, ALLOY C36000, 1/2 HARD
BASE/METAL SLEEVE	N/A	N/A
INSULATION*	PTFE	PTFE PER ASTM D1710
NUT	N/A	N/A
WASHER	N/A	N/A

*For Insulation color, please see INSULATION COLOR OPTIONS on Page 2

FINISH - PLATING OPTIONS:

1133-01M-XXXX

FINISH CODE	COMPONENT	FINISH	FINISH AND SPECIFICATION
05	TERMINAL	ELECTRO-SOLDER	0.000300"MIN. ELECTRO-SOLDER PER SAE-AMS-P-81728 OVER 0.000100"MIN. COPPER PER SAE-AMS-2418
	BASE/METAL SLEEVE	N/A	N/A
	NUT	N/A	N/A
	WASHER	N/A	N/A
088	TERMINAL	BRIGHT TIN-LEAD	0.000300"MIN. BRIGHT TIN-LEAD (Sn93%-Pb7%) PER ASTM B545 OVER 0.000100"MIN. COPPER PER SAE-AMS-2418
	BASE/METAL SLEEVE	N/A	N/A
	NUT	N/A	N/A
	WASHER	N/A	N/A
095	TERMINAL	HOT SOLDER DIP	0.000100"MIN. HOT SOLDER DIP USING Sn60 PER IPC-J-STD-006 OVER 0.000100"MIN. COPPER PER SAE-AMS-2418
	BASE/METAL SLEEVE	N/A	N/A
	NUT	N/A	N/A
	WASHER	N/A	N/A

INSULATION COLOR OPTIONS:

1133-01M-XXXX

INSULATION COLOR	BLACK	BLUE	BROWN	GRAY	GREEN	ORANGE	RED	VIOLET	WHITE	YELLOW
COLOR CODE NO.	10	16	11	18	15	13	12	17	19	14

TOLERANCES:*

DECIMAL	FRACTIONAL	ANGULAR	DRAWING ORIENTATION DATE	LAST MODIFICATION DATE
± 0.015	± 1/64	± 3 °	5/23/1998	3/1/2017

*All dimensions are in inches.

RoHS COMPLIANCE:

1133-01M-05XX

PART NUMBER	RoHS COMPLIANT
1133-01M-0510	NO
1133-01M-0511	NO
1133-01M-0512	NO
1133-01M-0513	NO
1133-01M-0514	NO
1133-01M-0515	NO
1133-01M-0516	NO
1133-01M-0517	NO
1133-01M-0518	NO
1133-01M-0519	NO

1133-01M-088XX

PART NUMBER	RoHS COMPLIANT
1133-01M-08810	NO
1133-01M-08811	NO
1133-01M-08812	NO
1133-01M-08813	NO
1133-01M-08814	NO
1133-01M-08815	NO
1133-01M-08816	NO
1133-01M-08817	NO
1133-01M-08818	NO
1133-01M-08819	NO

1133-01M-095XX

PART NUMBER	RoHS COMPLIANT
1133-01M-09510	NO
1133-01M-09511	NO
1133-01M-09512	NO
1133-01M-09513	NO
1133-01M-09514	NO
1133-01M-09515	NO
1133-01M-09516	NO
1133-01M-09517	NO
1133-01M-09518	NO
1133-01M-09519	NO

MILITARY REFERENCE SPECIFICATIONS:

1133-01M-05XX

PART NUMBER	MIL SPECIFICATION	MIL PART NUMBER	COMMERCIAL ITEM DESCRIPTION (CID) SPECIFICATION	CID PART NUMBER
1133-01M-0510	MIL-T-55155/04	M55155/040H01 (FT040B01S)	A-A-59126/04	AA59126/040H01
1133-01M-0511	MIL-T-55155/04	M55155/041H01 (FT041B01S)	A-A-59126/04	AA59126/041H01
1133-01M-0512	MIL-T-55155/04	M55155/042H01 (FT042B01S)	A-A-59126/04	AA59126/042H01
1133-01M-0513	MIL-T-55155/04	M55155/043H01 (FT043B01S)	A-A-59126/04	AA59126/043H01
1133-01M-0514	MIL-T-55155/04	M55155/044H01 (FT044B01S)	A-A-59126/04	AA59126/044H01
1133-01M-0515	MIL-T-55155/04	M55155/045H01 (FT045B01S)	A-A-59126/04	AA59126/045H01
1133-01M-0516	MIL-T-55155/04	M55155/046H01 (FT046B01S)	A-A-59126/04	AA59126/046H01
1133-01M-0517	MIL-T-55155/04	M55155/047H01 (FT047B01S)	A-A-59126/04	AA59126/047H01
1133-01M-0518	MIL-T-55155/04	M55155/048H01 (FT048B01S)	A-A-59126/04	AA59126/048H01
1133-01M-0519	MIL-T-55155/04	M55155/049H01 (FT049B01S)	A-A-59126/04	AA59126/049H01

1133-01M-088XX

PART NUMBER	MIL SPECIFICATION	MIL PART NUMBER	COMMERCIAL ITEM DESCRIPTION (CID) SPECIFICATION	CID PART NUMBER
1133-01M-08810	MIL-T-55155/04	M55155/040J01	A-A-59126/04	AA59126/040J01 (AA59126/04001)
1133-01M-08811	MIL-T-55155/04	M55155/041J01	A-A-59126/04	AA59126/041J01 (AA59126/04101)
1133-01M-08812	MIL-T-55155/04	M55155/042J01	A-A-59126/04	AA59126/042J01 (AA59126/04201)
1133-01M-08813	MIL-T-55155/04	M55155/043J01	A-A-59126/04	AA59126/043J01 (AA59126/04301)
1133-01M-08814	MIL-T-55155/04	M55155/044J01	A-A-59126/04	AA59126/044J01 (AA59126/04401)

Continued on next page...

MILITARY REFERENCE SPECIFICATIONS CONTINUED:

1133-01M-088XX

PART NUMBER	MIL SPECIFICATION	MIL PART NUMBER	COMMERCIAL ITEM DESCRIPTION (CID) SPECIFICATION	CID PART NUMBER
1133-01M-08815	MIL-T-55155/04	M55155/045J01	A-A-59126/04	AA59126/045J01 (AA59126/04501)
1133-01M-08816	MIL-T-55155/04	M55155/046J01	A-A-59126/04	AA59126/046J01 (AA59126/04601)
1133-01M-08817	MIL-T-55155/04	M55155/047J01	A-A-59126/04	AA59126/047J01 (AA59126/04701)
1133-01M-08818	MIL-T-55155/04	M55155/048J01	A-A-59126/04	AA59126/048J01 (AA59126/04801)
1133-01M-08819	MIL-T-55155/04	M55155/049J01	A-A-59126/04	AA59126/049J01 (AA59126/04901)

1133-01M-095XX

PART NUMBER	MIL SPECIFICATION	MIL PART NUMBER	COMMERCIAL ITEM DESCRIPTION (CID) SPECIFICATION	CID PART NUMBER
1133-01M-09510	MIL-T-55155/04	M55155/040I01	A-A-59126/04	AA59126/040I01
1133-01M-09511	MIL-T-55155/04	M55155/041I01	A-A-59126/04	AA59126/041I01
1133-01M-09512	MIL-T-55155/04	M55155/042I01	A-A-59126/04	AA59126/042I01
1133-01M-09513	MIL-T-55155/04	M55155/043I01	A-A-59126/04	AA59126/043I01
1133-01M-09514	MIL-T-55155/04	M55155/044I01	A-A-59126/04	AA59126/044I01
1133-01M-09515	MIL-T-55155/04	M55155/045I01	A-A-59126/04	AA59126/045I01
1133-01M-09516	MIL-T-55155/04	M55155/046I01	A-A-59126/04	AA59126/046I01
1133-01M-09517	MIL-T-55155/04	M55155/047I01	A-A-59126/04	AA59126/047I01
1133-01M-09518	MIL-T-55155/04	M55155/048I01	A-A-59126/04	AA59126/048I01
1133-01M-09519	MIL-T-55155/04	M55155/049I01	A-A-59126/04	AA59126/049I01

TOOLING:

INSTALLATION TOOL: ARBOR PRESS	INSTALLATION TOOL: ANVIL (ARBOR PRESS OPERATED)	INSTALLATION TOOL: PRESS-FIT / ROLL SWAGE / RIVET PUNCH (ARBOR PRESS OPERATED)	INSTALLATION TOOL: PRESS-FIT (HAND OPERATED)
TM1	TA1133-01	TPI1133-01	TTI1133-01

NOTES:

DATASHEET NOTES

N/A

INSTRUCTION NOTES

SEE GENERAL PRESS FIT INSTALLATION INSTRUCTION ON CONCORD ELECTRONICS' WEBSITE WWW.CONCORD-ELECTRONICS.COM.