

DRAWING NUMBER:	1127-68M-XXXXZ
PRODUCT GROUP:	TERMINALS
SUB-GROUP:	MILITARY INSULATED TERMINALS
DESCRIPTION:	DIALLYL PHTHALATE INSULATED TURRET TERMINAL

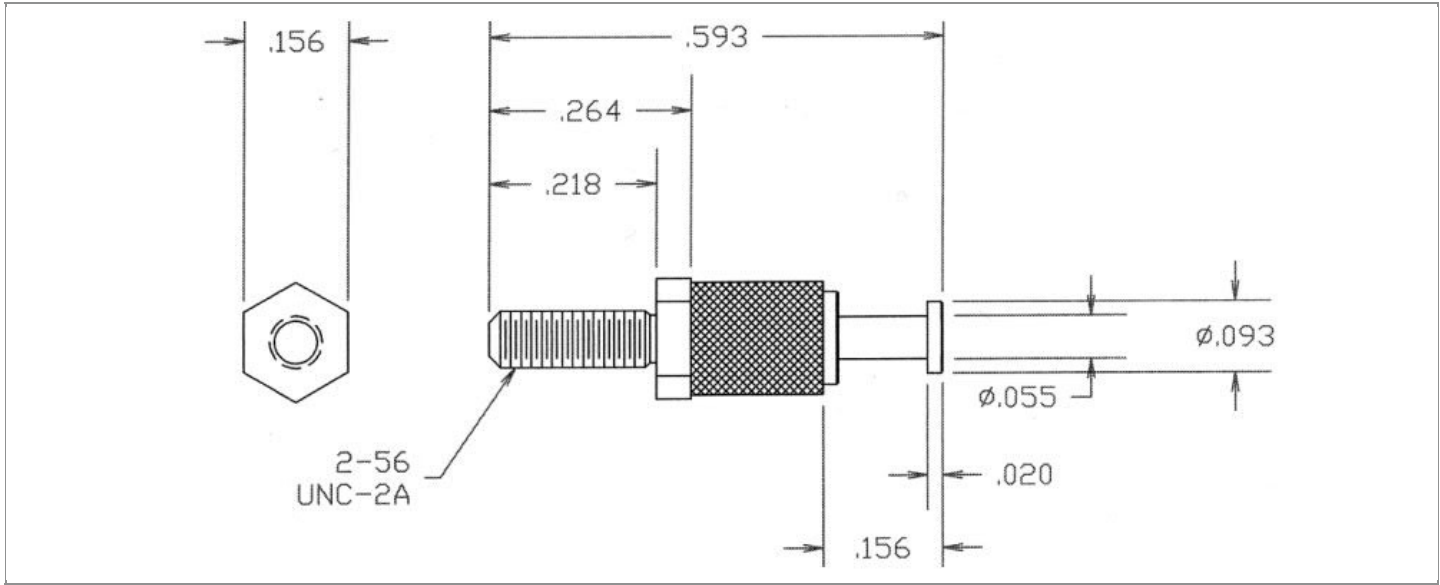

PIN DIAMETER	OVERALL LENGTH	MOUNTING ORIENTATION	BOARD / PANEL MOUNTING METHOD
N/A	0.593"	VERTICAL	THREAD MOUNT (2-56 NUT)
BOARD / PANEL THICKNESS	MOUNTING HOLE SIZE	DRILL SIZE	FEED THRU COMBINATION
UP TO 3/32"	0.094" ± 0.002	3/32"	N/A

PART NO. STRUCTURE:*

1127	-	68M	-	XX	XX
PART SERIES		DIMENSION		FINISH	INSULATION COLOR

*If applicable, "Z" at the end of a PART NO. STRUCTURE indicates TERMINAL MATERIAL TYPE.

MATERIAL OPTIONS:

1127-68M-XXXXZ

COMPONENT	MATERIAL	MATERIAL AND SPECIFICATION
TERMINAL	PHOSPHOR BRONZE	PHOSPHOR BRONZE PER ASTM B139, ALLOY C54400
BASE/METAL SLEEVE	BRASS	BRASS PER ASTM B16, ALLOY C36000, 1/2 HARD
INSULATION*	DIALLYL PHTHALATE	MOLDED DIALLYL PHTHALATE, TYPE SDG-F PER ASTM D5948
NUT	BRASS	BRASS PER ASTM B16, ALLOY C36000, 1/2 HARD
WASHER	PHOSPHOR BRONZE	PHOSPHOR BRONZE PER MS35333

*For Insulation color, please see INSULATION COLOR OPTIONS on Page 2

FINISH - PLATING OPTIONS:

1127-68M-XX~~XX~~Z

FINISH CODE	COMPONENT	FINISH	FINISH AND SPECIFICATION
05	TERMINAL	ELECTRO-SOLDER	0.000300"MIN. ELECTRO-SOLDER PER SAE-AMS-P-81728 OVER 0.000100"MIN. COPPER PER SAE-AMS-2418
	BASE/METAL SLEEVE	ELECTRO-SOLDER	0.000100"MIN. ELECTRO-SOLDER PER SAE-AMS-P-81728 OVER 0.000100"MIN. NICKEL PER SAE-AMS-QQ-N-290
	NUT	NICKEL	0.000100"MIN. NICKEL PER SAE-AMS-QQ-N-290
	WASHER	NICKEL	0.000100"MIN. NICKEL PER SAE-AMS-QQ-N-290
088	TERMINAL	BRIGHT TIN-LEAD	0.000300"MIN. BRIGHT TIN-LEAD (Sn93%-Pb7%) PER ASTM B545 OVER 0.000100"MIN. COPPER PER SAE-AMS-2418
	BASE/METAL SLEEVE	BRIGHT TIN-LEAD	0.000100"MIN. BRIGHT TIN-LEAD (Sn93%-Pb7%) PER ASTM B545 OVER 0.000100"MIN. NICKEL PER SAE-AMS-QQ-N-290
	NUT	NICKEL	0.000100"MIN. NICKEL PER SAE-AMS-QQ-N-290
	WASHER	NICKEL	0.000100"MIN. NICKEL PER SAE-AMS-QQ-N-290
095	TERMINAL	HOT SOLDER DIP	0.000100"MIN. HOT SOLDER DIP USING Sn60 PER IPC-J-STD-006 OVER 0.000100"MIN. COPPER PER SAE-AMS-2418
	BASE/METAL SLEEVE	BRIGHT TIN-LEAD	0.000100"MIN. BRIGHT TIN-LEAD (Sn93%-Pb7%) PER ASTM B545 OVER 0.000100"MIN. NICKEL PER SAE-AMS-QQ-N-290
	NUT	NICKEL	0.000100"MIN. NICKEL PER SAE-AMS-QQ-N-290
	WASHER	NICKEL	0.000100"MIN. NICKEL PER SAE-AMS-QQ-N-290

INSULATION COLOR OPTIONS:

1127-68M-XX~~XX~~Z

INSULATION COLOR	BLACK	BLUE	BROWN	GRAY	GREEN	ORANGE	RED	VIOLET	WHITE	YELLOW
COLOR CODE NO.	10	16	11	18	15	13	12	17	19	14

TOLERANCES:*

DECIMAL	FRACTIONAL	ANGULAR	DRAWING ORIGATION DATE	LAST MODIFICATION DATE
± 0.015	N/A	N/A	4/30/2001	3/1/2017

*All dimensions are in inches.

RoHS COMPLIANCE:

1127-68M-05XXZ

PART NUMBER	RoHS COMPLIANT
1127-68M-0510Z	NO
1127-68M-0511Z	NO
1127-68M-0512Z	NO
1127-68M-0513Z	NO
1127-68M-0514Z	NO
1127-68M-0515Z	NO
1127-68M-0516Z	NO
1127-68M-0517Z	NO
1127-68M-0518Z	NO
1127-68M-0519Z	NO

1127-68M-088XXZ

PART NUMBER	RoHS COMPLIANT
1127-68M-08810Z	NO
1127-68M-08811Z	NO
1127-68M-08812Z	NO
1127-68M-08813Z	NO
1127-68M-08814Z	NO
1127-68M-08815Z	NO
1127-68M-08816Z	NO
1127-68M-08817Z	NO
1127-68M-08818Z	NO
1127-68M-08819Z	NO

1127-68M-095XXZ

PART NUMBER	RoHS COMPLIANT
1127-68M-09510Z	NO
1127-68M-09511Z	NO
1127-68M-09512Z	NO
1127-68M-09513Z	NO
1127-68M-09514Z	NO
1127-68M-09515Z	NO
1127-68M-09516Z	NO
1127-68M-09517Z	NO
1127-68M-09518Z	NO
1127-68M-09519Z	NO

MILITARY REFERENCE SPECIFICATIONS:

1127-68M-05XXZ

PART NUMBER	MIL SPECIFICATION	MIL PART NUMBER	COMMERCIAL ITEM DESCRIPTION (CID) SPECIFICATION	CID PART NUMBER
1127-68M-0510Z	MIL-T-55155/18	M55155/180B01 (SE180E01Z)	A-A-59126/18	AA59126/180B01
1127-68M-0511Z	MIL-T-55155/18	M55155/181B01 (SE181E01Z)	A-A-59126/18	AA59126/181B01
1127-68M-0512Z	MIL-T-55155/18	M55155/182B01 (SE182E01Z)	A-A-59126/18	AA59126/182B01
1127-68M-0513Z	MIL-T-55155/18	M55155/183B01 (SE183E01Z)	A-A-59126/18	AA59126/183B01
1127-68M-0514Z	MIL-T-55155/18	M55155/184B01 (SE184E01Z)	A-A-59126/18	AA59126/184B01
1127-68M-0515Z	MIL-T-55155/18	M55155/185B01 (SE185E01Z)	A-A-59126/18	AA59126/185B01
1127-68M-0516Z	MIL-T-55155/18	M55155/186B01 (SE186E01Z)	A-A-59126/18	AA59126/186B01
1127-68M-0517Z	MIL-T-55155/18	M55155/187B01 (SE187E01Z)	A-A-59126/18	AA59126/187B01
1127-68M-0518Z	MIL-T-55155/18	M55155/188B01 (SE188E01Z)	A-A-59126/18	AA59126/188B01
1127-68M-0519Z	MIL-T-55155/18	M55155/189B01 (SE189E01Z)	A-A-59126/18	AA59126/189B01

1127-68M-088XXZ

PART NUMBER	MIL SPECIFICATION	MIL PART NUMBER	COMMERCIAL ITEM DESCRIPTION (CID) SPECIFICATION	CID PART NUMBER
1127-68M-08810Z	MIL-T-55155/18	M55155/180D01	A-A-59126/18	AA59126/180D01
1127-68M-08811Z	MIL-T-55155/18	M55155/181D01	A-A-59126/18	AA59126/181D01
1127-68M-08812Z	MIL-T-55155/18	M55155/182D01	A-A-59126/18	AA59126/182D01
1127-68M-08813Z	MIL-T-55155/18	M55155/183D01	A-A-59126/18	AA59126/183D01
1127-68M-08814Z	MIL-T-55155/18	M55155/184D01	A-A-59126/18	AA59126/184D01

Continued on next page...

MILITARY REFERENCE SPECIFICATIONS CONTINUED:

1127-68M-088XXZ

PART NUMBER	MIL SPECIFICATION	MIL PART NUMBER	COMMERCIAL ITEM DESCRIPTION (CID) SPECIFICATION	CID PART NUMBER
1127-68M-08815Z	MIL-T-55155/18	M55155/185D01	A-A-59126/18	AA59126/185D01
1127-68M-08816Z	MIL-T-55155/18	M55155/186D01	A-A-59126/18	AA59126/186D01
1127-68M-08817Z	MIL-T-55155/18	M55155/187D01	A-A-59126/18	AA59126/187D01
1127-68M-08818Z	MIL-T-55155/18	M55155/188D01	A-A-59126/18	AA59126/188D01
1127-68M-08819Z	MIL-T-55155/18	M55155/189D01	A-A-59126/18	AA59126/189D01

1127-68M-095XXZ

PART NUMBER	MIL SPECIFICATION	MIL PART NUMBER	COMMERCIAL ITEM DESCRIPTION (CID) SPECIFICATION	CID PART NUMBER
1127-68M-09510Z	MIL-T-55155/18	M55155/180C01	A-A-59126/18	AA59126/180C01
1127-68M-09511Z	MIL-T-55155/18	M55155/181C01	A-A-59126/18	AA59126/181C01
1127-68M-09512Z	MIL-T-55155/18	M55155/182C01	A-A-59126/18	AA59126/182C01
1127-68M-09513Z	MIL-T-55155/18	M55155/183C01	A-A-59126/18	AA59126/183C01
1127-68M-09514Z	MIL-T-55155/18	M55155/184C01	A-A-59126/18	AA59126/184C01
1127-68M-09515Z	MIL-T-55155/18	M55155/185C01	A-A-59126/18	AA59126/185C01
1127-68M-09516Z	MIL-T-55155/18	M55155/186C01	A-A-59126/18	AA59126/186C01
1127-68M-09517Z	MIL-T-55155/18	M55155/187C01	A-A-59126/18	AA59126/187C01
1127-68M-09518Z	MIL-T-55155/18	M55155/188C01	A-A-59126/18	AA59126/188C01
1127-68M-09519Z	MIL-T-55155/18	M55155/189C01	A-A-59126/18	AA59126/189C01

TOOLING:

INSTALLATION TOOL: ARBOR PRESS	INSTALLATION TOOL: ANVIL (ARBOR PRESS OPERATED)	INSTALLATION TOOL: PRESS-FIT / ROLL SWAGE / RIVET PUNCH (ARBOR PRESS OPERATED)	INSTALLATION TOOL: PRESS-FIT (HAND OPERATED)
N/A	N/A	N/A	N/A

NOTES:

DATASHEET NOTES

NUT PART NO.: 701-7312-02, WASHER PART NO.: 701-7701-02.

INSTRUCTION NOTES

SUPPLIED WITH NICKEL PLATED BRASS HEX NUT (2-56 x 3/16" x 1/16") AND NICKEL PLATED PHOSPHOR BRONZE #2 INTERNAL TOOTH LOCKWASHER.