

DRAWING NUMBER:	1127-07M-XXXX
PRODUCT GROUP:	TERMINALS
SUB-GROUP:	MILITARY INSULATED TERMINALS
DESCRIPTION:	DIALLYL PHTHALATE INSULATED DOUBLE TURRET TERMINAL

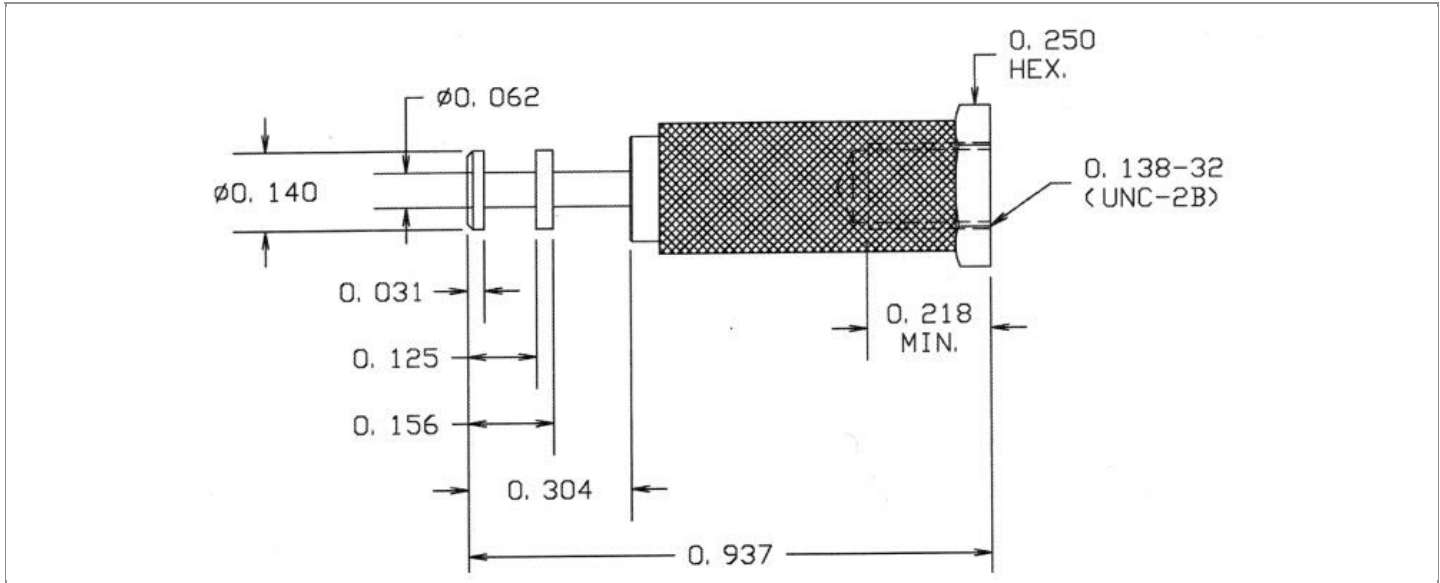

PIN DIAMETER	OVERALL LENGTH	MOUNTING ORIENTATION	BOARD / PANEL MOUNTING METHOD
N/A	0.937"	VERTICAL	THREAD MOUNT (6-32 SCREW)
BOARD / PANEL THICKNESS	MOUNTING HOLE SIZE	DRILL SIZE	FEED THRU COMBINATION
N/A	CLEARANCE FOR SCREW #6	#27	N/A

PART NO. STRUCTURE:*

1127	-	07M	-	XX	XX
PART SERIES		DIMENSION		FINISH	INSULATION COLOR

*If applicable, "Z" at the end of a PART NO. STRUCTURE indicates TERMINAL MATERIAL TYPE.

MATERIAL OPTIONS:

1127-07M-XXXX

COMPONENT	MATERIAL	MATERIAL AND SPECIFICATION
TERMINAL	BRASS	BRASS PER ASTM B16, ALLOY C36000, 1/2 HARD
BASE/METAL SLEEVE	BRASS	BRASS PER ASTM B16, ALLOY C36000, 1/2 HARD
INSULATION*	DIALLYL PHTHALATE	MOLDED DIALLYL PHTHALATE, TYPE SDG-F PER ASTM D5948
NUT	N/A	N/A
WASHER	N/A	N/A

*For Insulation color, please see INSULATION COLOR OPTIONS on Page 2

FINISH - PLATING OPTIONS:

1127-07M-XXXX

FINISH CODE	COMPONENT	FINISH	FINISH AND SPECIFICATION
05	TERMINAL	ELECTRO-SOLDER	0.000300"MIN. ELECTRO-SOLDER PER SAE-AMS-P-81728 OVER 0.000100"MIN. COPPER PER SAE-AMS-2418
	BASE/METAL SLEEVE	ELECTRO-SOLDER	0.000100"MIN. ELECTRO-SOLDER PER SAE-AMS-P-81728 OVER 0.000100"MIN. NICKEL PER SAE-AMS-QQ-N-290
	NUT	N/A	N/A
	WASHER	N/A	N/A
088	TERMINAL	BRIGHT TIN-LEAD	0.000300"MIN. BRIGHT TIN-LEAD (Sn93%-Pb7%) PER ASTM B545 OVER 0.000100"MIN. COPPER PER SAE-AMS-2418
	BASE/METAL SLEEVE	BRIGHT TIN-LEAD	0.000100"MIN. BRIGHT TIN-LEAD (Sn93%-Pb7%) PER ASTM B545 OVER 0.000100"MIN. NICKEL PER SAE-AMS-QQ-N-290
	NUT	N/A	N/A
	WASHER	N/A	N/A
095	TERMINAL	HOT SOLDER DIP	0.000100"MIN. HOT SOLDER DIP USING Sn60 PER IPC-J-STD-006 OVER 0.000100"MIN. COPPER PER SAE-AMS-2418
	BASE/METAL SLEEVE	BRIGHT TIN-LEAD	0.000100"MIN. BRIGHT TIN-LEAD (Sn93%-Pb7%) PER ASTM B545 OVER 0.000100"MIN. NICKEL PER SAE-AMS-QQ-N-290
	NUT	N/A	N/A
	WASHER	N/A	N/A

INSULATION COLOR OPTIONS:

1127-07M-XXXX

INSULATION COLOR	BLACK	BLUE	BROWN	GRAY	GREEN	ORANGE	RED	VIOLET	WHITE	YELLOW
COLOR CODE NO.	10	16	11	18	15	13	12	17	19	14

TOLERANCES:*

DECIMAL	FRACTIONAL	ANGULAR	DRAWING ORIGATION DATE	LAST MODIFICATION DATE
± 0.015	N/A	N/A	10/7/1997	3/1/2017

*All dimensions are in inches.

RoHS COMPLIANCE:

1127-07M-05XX

PART NUMBER	RoHS COMPLIANT
1127-07M-0510	NO
1127-07M-0511	NO
1127-07M-0512	NO
1127-07M-0513	NO
1127-07M-0514	NO
1127-07M-0515	NO
1127-07M-0516	NO
1127-07M-0517	NO
1127-07M-0518	NO
1127-07M-0519	NO

1127-07M-088XX

PART NUMBER	RoHS COMPLIANT
1127-07M-08810	NO
1127-07M-08811	NO
1127-07M-08812	NO
1127-07M-08813	NO
1127-07M-08814	NO
1127-07M-08815	NO
1127-07M-08816	NO
1127-07M-08817	NO
1127-07M-08818	NO
1127-07M-08819	NO

1127-07M-095XX

PART NUMBER	RoHS COMPLIANT
1127-07M-09510	NO
1127-07M-09511	NO
1127-07M-09512	NO
1127-07M-09513	NO
1127-07M-09514	NO
1127-07M-09515	NO
1127-07M-09516	NO
1127-07M-09517	NO
1127-07M-09518	NO
1127-07M-09519	NO

MILITARY REFERENCE SPECIFICATIONS:

1127-07M-05XX

PART NUMBER	MIL SPECIFICATION	MIL PART NUMBER	COMMERCIAL ITEM DESCRIPTION (CID) SPECIFICATION	CID PART NUMBER
1127-07M-0510	MIL-T-55155/20	M55155/200H04 (SE200D04S)	A-A-59126/20	AA59126/200H04
1127-07M-0511	MIL-T-55155/20	M55155/201H04 (SE201D04S)	A-A-59126/20	AA59126/201H04
1127-07M-0512	MIL-T-55155/20	M55155/202H04 (SE202D04S)	A-A-59126/20	AA59126/202H04
1127-07M-0513	MIL-T-55155/20	M55155/203H04 (SE203D04S)	A-A-59126/20	AA59126/203H04
1127-07M-0514	MIL-T-55155/20	M55155/204H04 (SE204D04S)	A-A-59126/20	AA59126/204H04
1127-07M-0515	MIL-T-55155/20	M55155/205H04 (SE205D04S)	A-A-59126/20	AA59126/205H04
1127-07M-0516	MIL-T-55155/20	M55155/206H04 (SE206D04S)	A-A-59126/20	AA59126/206H04
1127-07M-0517	MIL-T-55155/20	M55155/207H04 (SE207D04S)	A-A-59126/20	AA59126/207H04
1127-07M-0518	MIL-T-55155/20	M55155/208H04 (SE208D04S)	A-A-59126/20	AA59126/208H04
1127-07M-0519	MIL-T-55155/20	M55155/209H04 (SE209D04S)	A-A-59126/20	AA59126/209H04

1127-07M-088XX

PART NUMBER	MIL SPECIFICATION	MIL PART NUMBER	COMMERCIAL ITEM DESCRIPTION (CID) SPECIFICATION	CID PART NUMBER
1127-07M-08810	MIL-T-55155/20	M55155/200J04	A-A-59126/20	AA59126/200J04 (AA59126/20004)
1127-07M-08811	MIL-T-55155/20	M55155/201J04	A-A-59126/20	AA59126/201J04 (AA59126/20104)
1127-07M-08812	MIL-T-55155/20	M55155/202J04	A-A-59126/20	AA59126/202J04 (AA59126/20204)
1127-07M-08813	MIL-T-55155/20	M55155/203J04	A-A-59126/20	AA59126/203J04 (AA59126/20304)
1127-07M-08814	MIL-T-55155/20	M55155/204J04	A-A-59126/20	AA59126/204J04 (AA59126/20404)

Continued on next page...

MILITARY REFERENCE SPECIFICATIONS CONTINUED:

1127-07M-088XX

PART NUMBER	MIL SPECIFICATION	MIL PART NUMBER	COMMERCIAL ITEM DESCRIPTION (CID) SPECIFICATION	CID PART NUMBER
1127-07M-08815	MIL-T-55155/20	M55155/205J04	A-A-59126/20	AA59126/205J04 (AA59126/20504)
1127-07M-08816	MIL-T-55155/20	M55155/206J04	A-A-59126/20	AA59126/206J04 (AA59126/20604)
1127-07M-08817	MIL-T-55155/20	M55155/207J04	A-A-59126/20	AA59126/207J04 (AA59126/20704)
1127-07M-08818	MIL-T-55155/20	M55155/208J04	A-A-59126/20	AA59126/208J04 (AA59126/20804)
1127-07M-08819	MIL-T-55155/20	M55155/209J04	A-A-59126/20	AA59126/209J04 (AA59126/20904)

1127-07M-095XX

PART NUMBER	MIL SPECIFICATION	MIL PART NUMBER	COMMERCIAL ITEM DESCRIPTION (CID) SPECIFICATION	CID PART NUMBER
1127-07M-09510	MIL-T-55155/20	M55155/200I04	A-A-59126/20	AA59126/200I04
1127-07M-09511	MIL-T-55155/20	M55155/201I04	A-A-59126/20	AA59126/201I04
1127-07M-09512	MIL-T-55155/20	M55155/202I04	A-A-59126/20	AA59126/202I04
1127-07M-09513	MIL-T-55155/20	M55155/203I04	A-A-59126/20	AA59126/203I04
1127-07M-09514	MIL-T-55155/20	M55155/204I04	A-A-59126/20	AA59126/204I04
1127-07M-09515	MIL-T-55155/20	M55155/205I04	A-A-59126/20	AA59126/205I04
1127-07M-09516	MIL-T-55155/20	M55155/206I04	A-A-59126/20	AA59126/206I04
1127-07M-09517	MIL-T-55155/20	M55155/207I04	A-A-59126/20	AA59126/207I04
1127-07M-09518	MIL-T-55155/20	M55155/208I04	A-A-59126/20	AA59126/208I04
1127-07M-09519	MIL-T-55155/20	M55155/209I04	A-A-59126/20	AA59126/209I04

TOOLING:

INSTALLATION TOOL: ARBOR PRESS	INSTALLATION TOOL: ANVIL (ARBOR PRESS OPERATED)	INSTALLATION TOOL: PRESS-FIT / ROLL SWAGE / RIVET PUNCH (ARBOR PRESS OPERATED)	INSTALLATION TOOL: PRESS-FIT (HAND OPERATED)
N/A	N/A	N/A	N/A

NOTES:

DATASHEET NOTES
SCREW IS NOT INCLUDED.
INSTRUCTION NOTES
N/A