

DRAWING NUMBER:	1127-07M-XXXXZ
PRODUCT GROUP:	TERMINALS
SUB-GROUP:	MILITARY INSULATED TERMINALS
DESCRIPTION:	DIALLYL PHTHALATE INSULATED DOUBLE TURRET TERMINAL

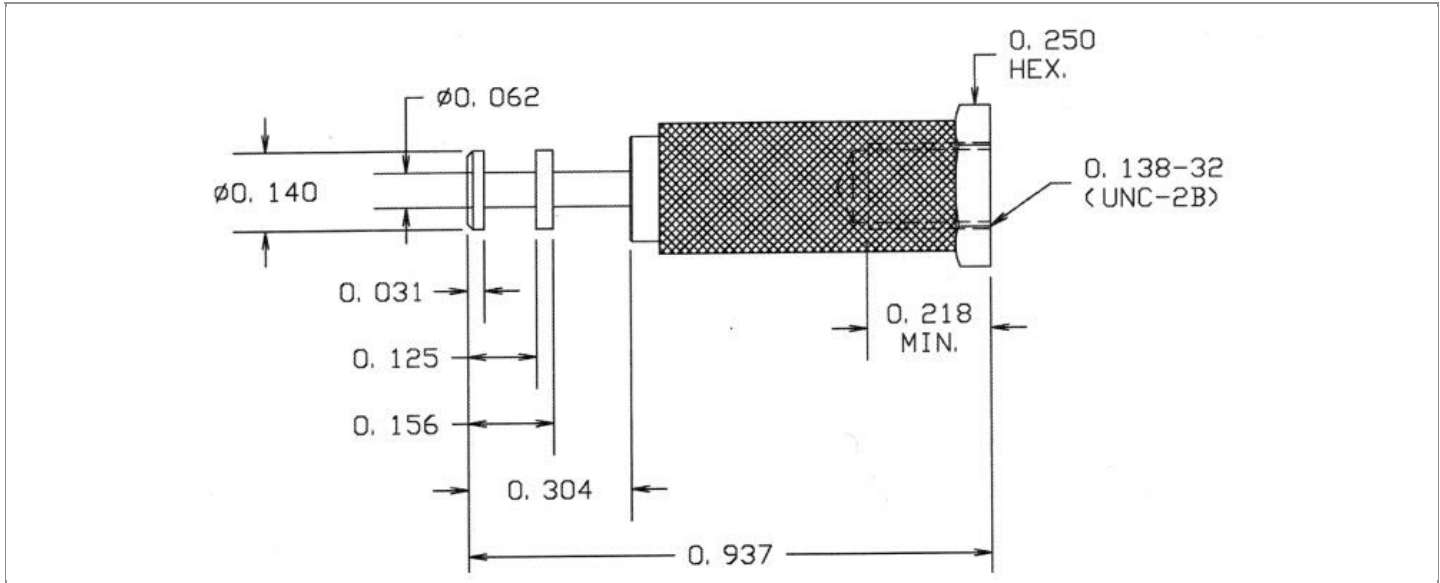

PIN DIAMETER	OVERALL LENGTH	MOUNTING ORIENTATION	BOARD / PANEL MOUNTING METHOD
N/A	0.937"	VERTICAL	THREAD MOUNT (6-32 SCREW)
BOARD / PANEL THICKNESS	MOUNTING HOLE SIZE	DRILL SIZE	FEED THRU COMBINATION
N/A	CLEARANCE FOR SCREW #6	#27	N/A

PART NO. STRUCTURE:*

1127	-	07M	-	XX	XX
PART SERIES		DIMENSION		FINISH	INSULATION COLOR

*If applicable, "Z" at the end of a PART NO. STRUCTURE indicates TERMINAL MATERIAL TYPE.

MATERIAL OPTIONS:

1127-07M-XXXXZ

COMPONENT	MATERIAL	MATERIAL AND SPECIFICATION
TERMINAL	PHOSPHOR BRONZE	PHOSPHOR BRONZE PER ASTM B139, ALLOY C54400
BASE/METAL SLEEVE	BRASS	BRASS PER ASTM B16, ALLOY C36000, 1/2 HARD
INSULATION*	DIALLYL PHTHALATE	MOLDED DIALLYL PHTHALATE, TYPE SDG-F PER ASTM D5948
NUT	N/A	N/A
WASHER	N/A	N/A

*For Insulation color, please see INSULATION COLOR OPTIONS on Page 2

FINISH - PLATING OPTIONS:

1127-07M-XXXXZ

FINISH CODE	COMPONENT	FINISH	FINISH AND SPECIFICATION
05	TERMINAL	ELECTRO-SOLDER	0.000300"MIN. ELECTRO-SOLDER PER SAE-AMS-P-81728 OVER 0.000100"MIN. COPPER PER SAE-AMS-2418
	BASE/METAL SLEEVE	ELECTRO-SOLDER	0.000100"MIN. ELECTRO-SOLDER PER SAE-AMS-P-81728 OVER 0.000100"MIN. NICKEL PER SAE-AMS-QQ-N-290
	NUT	N/A	N/A
	WASHER	N/A	N/A
088	TERMINAL	BRIGHT TIN-LEAD	0.000300"MIN. BRIGHT TIN-LEAD (Sn93%-Pb7%) PER ASTM B545 OVER 0.000100"MIN. COPPER PER SAE-AMS-2418
	BASE/METAL SLEEVE	BRIGHT TIN-LEAD	0.000100"MIN. BRIGHT TIN-LEAD (Sn93%-Pb7%) PER ASTM B545 OVER 0.000100"MIN. NICKEL PER SAE-AMS-QQ-N-290
	NUT	N/A	N/A
	WASHER	N/A	N/A
095	TERMINAL	HOT SOLDER DIP	0.000100"MIN. HOT SOLDER DIP USING Sn60 PER IPC-J-STD-006 OVER 0.000100"MIN. COPPER PER SAE-AMS-2418
	BASE/METAL SLEEVE	BRIGHT TIN-LEAD	0.000100"MIN. BRIGHT TIN-LEAD (Sn93%-Pb7%) PER ASTM B545 OVER 0.000100"MIN. NICKEL PER SAE-AMS-QQ-N-290
	NUT	N/A	N/A
	WASHER	N/A	N/A

INSULATION COLOR OPTIONS:

1127-07M-XXXXZ

INSULATION COLOR	BLACK	BLUE	BROWN	GRAY	GREEN	ORANGE	RED	VIOLET	WHITE	YELLOW
COLOR CODE NO.	10	16	11	18	15	13	12	17	19	14

TOLERANCES:*

DECIMAL	FRACTIONAL	ANGULAR	DRAWING ORIGATION DATE	LAST MODIFICATION DATE
± 0.015	N/A	N/A	10/7/1997	3/1/2017

*All dimensions are in inches.

RoHS COMPLIANCE:

1127-07M-05XXZ

PART NUMBER	RoHS COMPLIANT
1127-07M-0510Z	NO
1127-07M-0511Z	NO
1127-07M-0512Z	NO
1127-07M-0513Z	NO
1127-07M-0514Z	NO
1127-07M-0515Z	NO
1127-07M-0516Z	NO
1127-07M-0517Z	NO
1127-07M-0518Z	NO
1127-07M-0519Z	NO

1127-07M-088XXZ

PART NUMBER	RoHS COMPLIANT
1127-07M-08810Z	NO
1127-07M-08811Z	NO
1127-07M-08812Z	NO
1127-07M-08813Z	NO
1127-07M-08814Z	NO
1127-07M-08815Z	NO
1127-07M-08816Z	NO
1127-07M-08817Z	NO
1127-07M-08818Z	NO
1127-07M-08819Z	NO

1127-07M-095XXZ

PART NUMBER	RoHS COMPLIANT
1127-07M-09510Z	NO
1127-07M-09511Z	NO
1127-07M-09512Z	NO
1127-07M-09513Z	NO
1127-07M-09514Z	NO
1127-07M-09515Z	NO
1127-07M-09516Z	NO
1127-07M-09517Z	NO
1127-07M-09518Z	NO
1127-07M-09519Z	NO

MILITARY REFERENCE SPECIFICATIONS:

1127-07M-05XXZ

PART NUMBER	MIL SPECIFICATION	MIL PART NUMBER	COMMERCIAL ITEM DESCRIPTION (CID) SPECIFICATION	CID PART NUMBER
1127-07M-0510Z	MIL-T-55155/20	M55155/200B04 (SE200D04Z)	A-A-59126/20	AA59126/200B04
1127-07M-0511Z	MIL-T-55155/20	M55155/201B04 (SE201D04Z)	A-A-59126/20	AA59126/201B04
1127-07M-0512Z	MIL-T-55155/20	M55155/202B04 (SE202D04Z)	A-A-59126/20	AA59126/202B04
1127-07M-0513Z	MIL-T-55155/20	M55155/203B04 (SE203D04Z)	A-A-59126/20	AA59126/203B04
1127-07M-0514Z	MIL-T-55155/20	M55155/204B04 (SE204D04Z)	A-A-59126/20	AA59126/204B04
1127-07M-0515Z	MIL-T-55155/20	M55155/205B04 (SE205D04Z)	A-A-59126/20	AA59126/205B04
1127-07M-0516Z	MIL-T-55155/20	M55155/206B04 (SE206D04Z)	A-A-59126/20	AA59126/206B04
1127-07M-0517Z	MIL-T-55155/20	M55155/207B04 (SE207D04Z)	A-A-59126/20	AA59126/207B04
1127-07M-0518Z	MIL-T-55155/20	M55155/208B04 (SE208D04Z)	A-A-59126/20	AA59126/208B04
1127-07M-0519Z	MIL-T-55155/20	M55155/209B04 (SE209D04Z)	A-A-59126/20	AA59126/209B04

1127-07M-088XXZ

PART NUMBER	MIL SPECIFICATION	MIL PART NUMBER	COMMERCIAL ITEM DESCRIPTION (CID) SPECIFICATION	CID PART NUMBER
1127-07M-08810Z	MIL-T-55155/20	M55155/200D04	A-A-59126/20	AA59126/200D04
1127-07M-08811Z	MIL-T-55155/20	M55155/201D04	A-A-59126/20	AA59126/201D04
1127-07M-08812Z	MIL-T-55155/20	M55155/202D04	A-A-59126/20	AA59126/202D04
1127-07M-08813Z	MIL-T-55155/20	M55155/203D04	A-A-59126/20	AA59126/203D04
1127-07M-08814Z	MIL-T-55155/20	M55155/204D04	A-A-59126/20	AA59126/204D04

Continued on next page...

MILITARY REFERENCE SPECIFICATIONS CONTINUED:

1127-07M-088XXZ

PART NUMBER	MIL SPECIFICATION	MIL PART NUMBER	COMMERCIAL ITEM DESCRIPTION (CID) SPECIFICATION	CID PART NUMBER
1127-07M-08815Z	MIL-T-55155/20	M55155/205D04	A-A-59126/20	AA59126/205D04
1127-07M-08816Z	MIL-T-55155/20	M55155/206D04	A-A-59126/20	AA59126/206D04
1127-07M-08817Z	MIL-T-55155/20	M55155/207D04	A-A-59126/20	AA59126/207D04
1127-07M-08818Z	MIL-T-55155/20	M55155/208D04	A-A-59126/20	AA59126/208D04
1127-07M-08819Z	MIL-T-55155/20	M55155/209D04	A-A-59126/20	AA59126/209D04

1127-07M-095XXZ

PART NUMBER	MIL SPECIFICATION	MIL PART NUMBER	COMMERCIAL ITEM DESCRIPTION (CID) SPECIFICATION	CID PART NUMBER
1127-07M-09510Z	MIL-T-55155/20	M55155/200C04	A-A-59126/20	AA59126/200C04
1127-07M-09511Z	MIL-T-55155/20	M55155/201C04	A-A-59126/20	AA59126/201C04
1127-07M-09512Z	MIL-T-55155/20	M55155/202C04	A-A-59126/20	AA59126/202C04
1127-07M-09513Z	MIL-T-55155/20	M55155/203C04	A-A-59126/20	AA59126/203C04
1127-07M-09514Z	MIL-T-55155/20	M55155/204C04	A-A-59126/20	AA59126/204C04
1127-07M-09515Z	MIL-T-55155/20	M55155/205C04	A-A-59126/20	AA59126/205C04
1127-07M-09516Z	MIL-T-55155/20	M55155/206C04	A-A-59126/20	AA59126/206C04
1127-07M-09517Z	MIL-T-55155/20	M55155/207C04	A-A-59126/20	AA59126/207C04
1127-07M-09518Z	MIL-T-55155/20	M55155/208C04	A-A-59126/20	AA59126/208C04
1127-07M-09519Z	MIL-T-55155/20	M55155/209C04	A-A-59126/20	AA59126/209C04

TOOLING:

INSTALLATION TOOL: ARBOR PRESS	INSTALLATION TOOL: ANVIL (ARBOR PRESS OPERATED)	INSTALLATION TOOL: PRESS-FIT / ROLL SWAGE / RIVET PUNCH (ARBOR PRESS OPERATED)	INSTALLATION TOOL: PRESS-FIT (HAND OPERATED)
N/A	N/A	N/A	N/A

NOTES:

DATASHEET NOTES
SCREW IS NOT INCLUDED.
INSTRUCTION NOTES
N/A