

<b>DRAWING NUMBER:</b>	<b>01-2126-1-XXXX</b>
<b>PRODUCT GROUP:</b>	BANANA PLUGS, JACKS AND PHONE TIPS
<b>SUB-GROUP:</b>	INSULATED BANANA PLUGS
<b>DESCRIPTION:</b>	INSULATED RIGHT ANGLE METER STANDARD BANANA PLUG

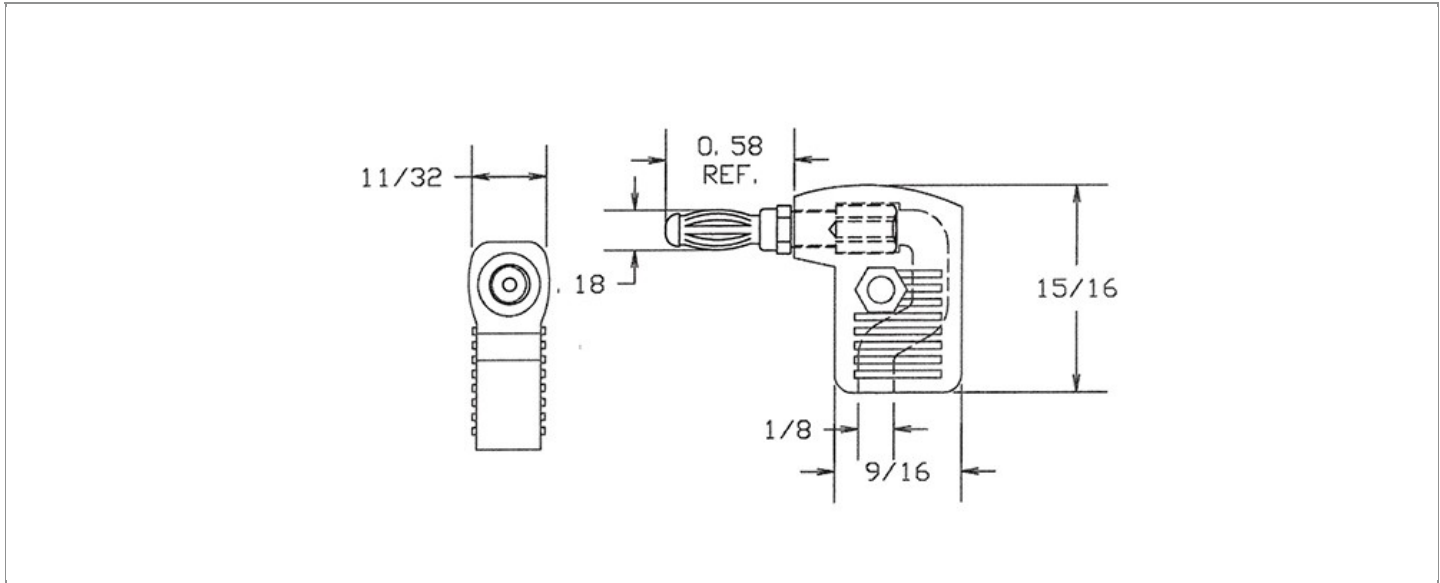

ACCEPTS PIN / PLUG / JACK SIZE	OVERALL LENGTH	CABLE / WIRE SIZE
STANDARD BANANA JACK	1.160"	ACCEPTS UP TO 18 AWG WIRE

**PART NO. STRUCTURE:**

01-2126	-	1	-	XX	XX
PART SERIES		DIMENSION		FINISH	INSULATION COLOR

**MATERIAL OPTIONS:**

**01-2126-1-XXXX**

COMPONENT	MATERIAL	MATERIAL AND SPECIFICATION
BODY	BRASS	BRASS PER ASTM B16, ALLOY C36000, 1/2 HARD
SPRING (CAGE)	BERYLLIUM COPPER	BERYLLIUM COPPER PER ASTM B194, ALLOY C17200
INSULATION*	BUTYRATE	BUTYRATE PER ASTM D707
TERMINAL	N/A	N/A
SET SCREW	N/A	N/A
STUD	N/A	N/A
JACK SPRING	N/A	N/A

\*For Insulation color, please see INSULATION COLOR OPTIONS on Page 2

FINISH - PLATING OPTIONS:

01-2126-1-XXXX

FINISH CODE	COMPONENT	FINISH	FINISH AND SPECIFICATION
02	BODY	NICKEL	0.000100"MIN. NICKEL PER SAE-AMS-QQ-N-290
	SPRING (CAGE)	NICKEL	0.000200"MIN. NICKEL PER SAE-AMS-QQ-N-290
	TERMINAL	N/A	N/A
	SET SCREW	N/A	N/A
	STUD	N/A	N/A
	JACK SPRING	N/A	N/A

INSULATION COLOR OPTIONS:

01-2126-1-XXXX

INSULATION COLOR	BLACK	BLUE	BROWN	GRAY	GREEN	ORANGE	RED	VIOLET	WHITE	YELLOW
COLOR CODE NO.	10	16	11	18	15	13	12	17	19	14

TOLERANCES:\*

DECIMAL	FRACTIONAL	ANGULAR	DRAWING ORIGATION DATE	LAST MODIFICATION DATE
± 0.010	± 1/64	± 5 °	5/19/1998	4/1/2017

\*All dimensions are in inches.

RoHS COMPLIANCE:

01-2126-1-02XX

PART NUMBER	RoHS COMPLIANT
01-2126-1-0210	YES
01-2126-1-0211	YES
01-2126-1-0212	YES
01-2126-1-0213	YES
01-2126-1-0214	YES
01-2126-1-0215	YES
01-2126-1-0216	YES
01-2126-1-0217	YES
01-2126-1-0218	YES
01-2126-1-0219	YES

**NOTES:**

---

**DATASHEET NOTES**

RATED: 10 AMPERES FOR STANDARD BANANA JACK. NUT PART NUMBER: 701-7355. SCREW PART NUMBER: 701-7110.

---

**INSTRUCTION NOTES**

SUPPLIED WITH NICKEL PLATED STEEL HEX NUT (3-48 x 3/16" x 1/16") AND NICKEL PLATED STEEL BINDING HEAD SCREW (3-48 x 1/4").

---