

DRAWING NUMBER:	1127-05M-XXXXZ
PRODUCT GROUP:	TERMINALS
SUB-GROUP:	MILITARY INSULATED TERMINALS
DESCRIPTION:	DIALLYL PHTHALATE INSULATED DOUBLE TURRET TERMINAL

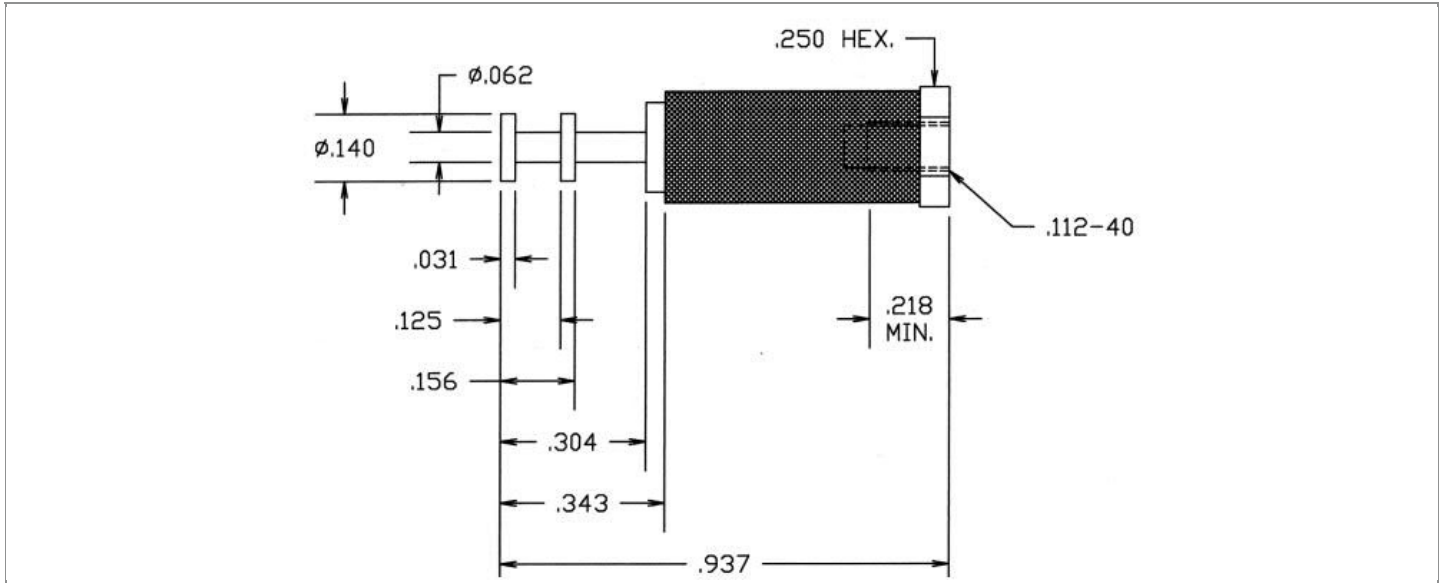

PIN DIAMETER	OVERALL LENGTH	MOUNTING ORIENTATION	BOARD / PANEL MOUNTING METHOD
N/A	0.937"	VERTICAL	THREAD MOUNT (4-40 SCREW)
BOARD / PANEL THICKNESS	MOUNTING HOLE SIZE	DRILL SIZE	FEED THRU COMBINATION
N/A	CLEARANCE FOR SCREW #4	#31	N/A

PART NO. STRUCTURE:*

1127	-	05M	-	XX	XX
PART SERIES		DIMENSION		FINISH	INSULATION COLOR

*If applicable, "Z" at the end of a PART NO. STRUCTURE indicates TERMINAL MATERIAL TYPE.

MATERIAL OPTIONS:

1127-05M-XXXXZ

COMPONENT	MATERIAL	MATERIAL AND SPECIFICATION
TERMINAL	PHOSPHOR BRONZE	PHOSPHOR BRONZE PER ASTM B139, ALLOY C54400
BASE/METAL SLEEVE	BRASS	BRASS PER ASTM B16, ALLOY C36000, 1/2 HARD
INSULATION*	DIALLYL PHTHALATE	MOLDED DIALLYL PHTHALATE, TYPE SDG-F PER ASTM D5948
NUT	N/A	N/A
WASHER	N/A	N/A

*For Insulation color, please see INSULATION COLOR OPTIONS on Page 2

FINISH - PLATING OPTIONS:

1127-05M-XX~~XX~~Z

FINISH CODE	COMPONENT	FINISH	FINISH AND SPECIFICATION
05	TERMINAL	ELECTRO-SOLDER	0.000300"MIN. ELECTRO-SOLDER PER SAE-AMS-P-81728 OVER 0.000100"MIN. COPPER PER SAE-AMS-2418
	BASE/METAL SLEEVE	ELECTRO-SOLDER	0.000100"MIN. ELECTRO-SOLDER PER SAE-AMS-P-81728 OVER 0.000100"MIN. NICKEL PER SAE-AMS-QQ-N-290
	NUT	N/A	N/A
	WASHER	N/A	N/A
088	TERMINAL	BRIGHT TIN-LEAD	0.000300"MIN. BRIGHT TIN-LEAD (Sn93%-Pb7%) PER ASTM B545 OVER 0.000100"MIN. COPPER PER SAE-AMS-2418
	BASE/METAL SLEEVE	BRIGHT TIN-LEAD	0.000100"MIN. BRIGHT TIN-LEAD (Sn93%-Pb7%) PER ASTM B545 OVER 0.000100"MIN. NICKEL PER SAE-AMS-QQ-N-290
	NUT	N/A	N/A
	WASHER	N/A	N/A
095	TERMINAL	HOT SOLDER DIP	0.000100"MIN. HOT SOLDER DIP USING Sn60 PER IPC-J-STD-006 OVER 0.000100"MIN. COPPER PER SAE-AMS-2418
	BASE/METAL SLEEVE	BRIGHT TIN-LEAD	0.000100"MIN. BRIGHT TIN-LEAD (Sn93%-Pb7%) PER ASTM B545 OVER 0.000100"MIN. NICKEL PER SAE-AMS-QQ-N-290
	NUT	N/A	N/A
	WASHER	N/A	N/A

INSULATION COLOR OPTIONS:

1127-05M-XX~~XX~~Z

INSULATION COLOR	BLACK	BLUE	BROWN	GRAY	GREEN	ORANGE	RED	VIOLET	WHITE	YELLOW
COLOR CODE NO.	10	16	11	18	15	13	12	17	19	14

TOLERANCES:*

DECIMAL	FRACTIONAL	ANGULAR	DRAWING ORIGATION DATE	LAST MODIFICATION DATE
± 0.015	N/A	N/A	12/19/2003	3/1/2017

*All dimensions are in inches.

RoHS COMPLIANCE:

1127-05M-05XXZ

PART NUMBER	RoHS COMPLIANT
1127-05M-0510Z	NO
1127-05M-0511Z	NO
1127-05M-0512Z	NO
1127-05M-0513Z	NO
1127-05M-0514Z	NO
1127-05M-0515Z	NO
1127-05M-0516Z	NO
1127-05M-0517Z	NO
1127-05M-0518Z	NO
1127-05M-0519Z	NO

1127-05M-088XXZ

PART NUMBER	RoHS COMPLIANT
1127-05M-08810Z	NO
1127-05M-08811Z	NO
1127-05M-08812Z	NO
1127-05M-08813Z	NO
1127-05M-08814Z	NO
1127-05M-08815Z	NO
1127-05M-08816Z	NO
1127-05M-08817Z	NO
1127-05M-08818Z	NO
1127-05M-08819Z	NO

1127-05M-095XXZ

PART NUMBER	RoHS COMPLIANT
1127-05M-09510Z	NO
1127-05M-09511Z	NO
1127-05M-09512Z	NO
1127-05M-09513Z	NO
1127-05M-09514Z	NO
1127-05M-09515Z	NO
1127-05M-09516Z	NO
1127-05M-09517Z	NO
1127-05M-09518Z	NO
1127-05M-09519Z	NO

MILITARY REFERENCE SPECIFICATIONS:

1127-05M-05XXZ

PART NUMBER	MIL SPECIFICATION	MIL PART NUMBER	COMMERCIAL ITEM DESCRIPTION (CID) SPECIFICATION	CID PART NUMBER
1127-05M-0510Z	MIL-T-55155/20	M55155/200B02 (SE200D02Z)	A-A-59126/20	AA59126/200B02
1127-05M-0511Z	MIL-T-55155/20	M55155/201B02 (SE201D02Z)	A-A-59126/20	AA59126/201B02
1127-05M-0512Z	MIL-T-55155/20	M55155/202B02 (SE202D02Z)	A-A-59126/20	AA59126/202B02
1127-05M-0513Z	MIL-T-55155/20	M55155/203B02 (SE203D02Z)	A-A-59126/20	AA59126/203B02
1127-05M-0514Z	MIL-T-55155/20	M55155/204B02 (SE204D02Z)	A-A-59126/20	AA59126/204B02
1127-05M-0515Z	MIL-T-55155/20	M55155/205B02 (SE205D02Z)	A-A-59126/20	AA59126/205B02
1127-05M-0516Z	MIL-T-55155/20	M55155/206B02 (SE206D02Z)	A-A-59126/20	AA59126/206B02
1127-05M-0517Z	MIL-T-55155/20	M55155/207B02 (SE207D02Z)	A-A-59126/20	AA59126/207B02
1127-05M-0518Z	MIL-T-55155/20	M55155/208B02 (SE208D02Z)	A-A-59126/20	AA59126/208B02
1127-05M-0519Z	MIL-T-55155/20	M55155/209B02 (SE209D02Z)	A-A-59126/20	AA59126/209B02

1127-05M-088XXZ

PART NUMBER	MIL SPECIFICATION	MIL PART NUMBER	COMMERCIAL ITEM DESCRIPTION (CID) SPECIFICATION	CID PART NUMBER
1127-05M-08810Z	MIL-T-55155/20	M55155/200D02	A-A-59126/20	AA59126/200D02
1127-05M-08811Z	MIL-T-55155/20	M55155/201D02	A-A-59126/20	AA59126/201D02
1127-05M-08812Z	MIL-T-55155/20	M55155/202D02	A-A-59126/20	AA59126/202D02
1127-05M-08813Z	MIL-T-55155/20	M55155/203D02	A-A-59126/20	AA59126/203D02
1127-05M-08814Z	MIL-T-55155/20	M55155/204D02	A-A-59126/20	AA59126/204D02

Continued on next page...

MILITARY REFERENCE SPECIFICATIONS CONTINUED:

1127-05M-088XXZ

PART NUMBER	MIL SPECIFICATION	MIL PART NUMBER	COMMERCIAL ITEM DESCRIPTION (CID) SPECIFICATION	CID PART NUMBER
1127-05M-08815Z	MIL-T-55155/20	M55155/205D02	A-A-59126/20	AA59126/205D02
1127-05M-08816Z	MIL-T-55155/20	M55155/206D02	A-A-59126/20	AA59126/206D02
1127-05M-08817Z	MIL-T-55155/20	M55155/207D02	A-A-59126/20	AA59126/207D02
1127-05M-08818Z	MIL-T-55155/20	M55155/208D02	A-A-59126/20	AA59126/208D02
1127-05M-08819Z	MIL-T-55155/20	M55155/209D02	A-A-59126/20	AA59126/209D02

1127-05M-095XXZ

PART NUMBER	MIL SPECIFICATION	MIL PART NUMBER	COMMERCIAL ITEM DESCRIPTION (CID) SPECIFICATION	CID PART NUMBER
1127-05M-09510Z	MIL-T-55155/20	M55155/200C02	A-A-59126/20	AA59126/200C02
1127-05M-09511Z	MIL-T-55155/20	M55155/201C02	A-A-59126/20	AA59126/201C02
1127-05M-09512Z	MIL-T-55155/20	M55155/202C02	A-A-59126/20	AA59126/202C02
1127-05M-09513Z	MIL-T-55155/20	M55155/203C02	A-A-59126/20	AA59126/203C02
1127-05M-09514Z	MIL-T-55155/20	M55155/204C02	A-A-59126/20	AA59126/204C02
1127-05M-09515Z	MIL-T-55155/20	M55155/205C02	A-A-59126/20	AA59126/205C02
1127-05M-09516Z	MIL-T-55155/20	M55155/206C02	A-A-59126/20	AA59126/206C02
1127-05M-09517Z	MIL-T-55155/20	M55155/207C02	A-A-59126/20	AA59126/207C02
1127-05M-09518Z	MIL-T-55155/20	M55155/208C02	A-A-59126/20	AA59126/208C02
1127-05M-09519Z	MIL-T-55155/20	M55155/209C02	A-A-59126/20	AA59126/209C02

TOOLING:

INSTALLATION TOOL: ARBOR PRESS	INSTALLATION TOOL: ANVIL (ARBOR PRESS OPERATED)	INSTALLATION TOOL: PRESS-FIT / ROLL SWAGE / RIVET PUNCH (ARBOR PRESS OPERATED)	INSTALLATION TOOL: PRESS-FIT (HAND OPERATED)
N/A	N/A	N/A	N/A

NOTES:

DATASHEET NOTES
SCREW IS NOT INCLUDED.
INSTRUCTION NOTES
N/A