

DRAWING NUMBER:	1125-46M-XXXX
PRODUCT GROUP:	TERMINALS
SUB-GROUP:	MILITARY INSULATED TERMINALS
DESCRIPTION:	PTFE INSULATED DOUBLE TURRET TERMINAL

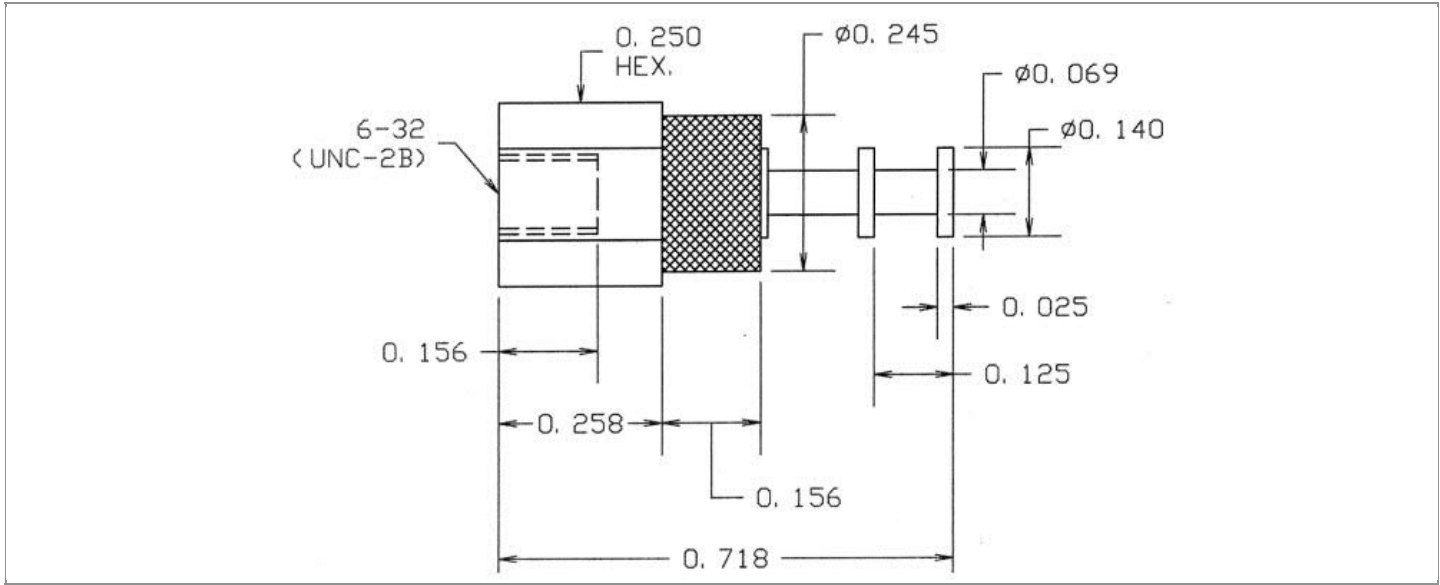

PIN DIAMETER	OVERALL LENGTH	MOUNTING ORIENTATION	BOARD / PANEL MOUNTING METHOD
N/A	0.718"	VERTICAL	THREAD MOUNT (6-32 SCREW)
BOARD / PANEL THICKNESS	MOUNTING HOLE SIZE	DRILL SIZE	FEED THRU COMBINATION
N/A	CLEARANCE FOR SCREW #6	#27	N/A

PART NO. STRUCTURE:*

1125	-	46M	-	XX		XX
PART SERIES		DIMENSION		FINISH		INSULATION COLOR

*If applicable, "Z" at the end of a PART NO. STRUCTURE indicates TERMINAL MATERIAL TYPE.

MATERIAL OPTIONS:

1125-46M-XXXX

COMPONENT	MATERIAL	MATERIAL AND SPECIFICATION
TERMINAL	BRASS	BRASS PER ASTM B16, ALLOY C36000, 1/2 HARD
BASE/METAL SLEEVE	BRASS	BRASS PER ASTM B16, ALLOY C36000, 1/2 HARD
INSULATION*	PTFE	PTFE PER ASTM D1710
NUT	N/A	N/A
WASHER	N/A	N/A

*For Insulation color, please see INSULATION COLOR OPTIONS on Page 2

FINISH - PLATING OPTIONS:

1125-46M-XXXX

FINISH CODE	COMPONENT	FINISH	FINISH AND SPECIFICATION
05	TERMINAL	ELECTRO-SOLDER	0.000300"MIN. ELECTRO-SOLDER PER SAE-AMS-P-81728 OVER 0.000100"MIN. COPPER PER SAE-AMS-2418
	BASE/METAL SLEEVE	ELECTRO-SOLDER	0.000100"MIN. ELECTRO-SOLDER PER SAE-AMS-P-81728 OVER 0.000100"MIN. NICKEL PER SAE-AMS-QQ-N-290
	NUT	N/A	N/A
	WASHER	N/A	N/A
088	TERMINAL	BRIGHT TIN-LEAD	0.000300"MIN. BRIGHT TIN-LEAD (Sn93%-Pb7%) PER ASTM B545 OVER 0.000100"MIN. COPPER PER SAE-AMS-2418
	BASE/METAL SLEEVE	BRIGHT TIN-LEAD	0.000100"MIN. BRIGHT TIN-LEAD (Sn93%-Pb7%) PER ASTM B545 OVER 0.000100"MIN. NICKEL PER SAE-AMS-QQ-N-290
	NUT	N/A	N/A
	WASHER	N/A	N/A
095	TERMINAL	HOT SOLDER DIP	0.000100"MIN. HOT SOLDER DIP USING Sn60 PER IPC-J-STD-006 OVER 0.000100"MIN. COPPER PER SAE-AMS-2418
	BASE/METAL SLEEVE	BRIGHT TIN-LEAD	0.000100"MIN. BRIGHT TIN-LEAD (Sn93%-Pb7%) PER ASTM B545 OVER 0.000100"MIN. NICKEL PER SAE-AMS-QQ-N-290
	NUT	N/A	N/A
	WASHER	N/A	N/A

INSULATION COLOR OPTIONS:

1125-46M-XXXX

INSULATION COLOR	BLACK	BLUE	BROWN	GRAY	GREEN	ORANGE	RED	VIOLET	WHITE	YELLOW
COLOR CODE NO.	10	16	11	18	15	13	12	17	19	14

TOLERANCES:*

DECIMAL	FRACTIONAL	ANGULAR	DRAWING ORIGATION DATE	LAST MODIFICATION DATE
± 0.015	N/A	N/A	8/6/1998	3/1/2017

*All dimensions are in inches.

RoHS COMPLIANCE:

1125-46M-05XX

PART NUMBER	RoHS COMPLIANT
1125-46M-0510	NO
1125-46M-0511	NO
1125-46M-0512	NO
1125-46M-0513	NO
1125-46M-0514	NO
1125-46M-0515	NO
1125-46M-0516	NO
1125-46M-0517	NO
1125-46M-0518	NO
1125-46M-0519	NO

1125-46M-088XX

PART NUMBER	RoHS COMPLIANT
1125-46M-08810	NO
1125-46M-08811	NO
1125-46M-08812	NO
1125-46M-08813	NO
1125-46M-08814	NO
1125-46M-08815	NO
1125-46M-08816	NO
1125-46M-08817	NO
1125-46M-08818	NO
1125-46M-08819	NO

1125-46M-095XX

PART NUMBER	RoHS COMPLIANT
1125-46M-09510	NO
1125-46M-09511	NO
1125-46M-09512	NO
1125-46M-09513	NO
1125-46M-09514	NO
1125-46M-09515	NO
1125-46M-09516	NO
1125-46M-09517	NO
1125-46M-09518	NO
1125-46M-09519	NO

MILITARY REFERENCE SPECIFICATIONS:

1125-46M-05XX

PART NUMBER	MIL SPECIFICATION	MIL PART NUMBER	COMMERCIAL ITEM DESCRIPTION (CID) SPECIFICATION	CID PART NUMBER
1125-46M-0510	MIL-T-55155/10	M55155/100H02 (SE100D02S)	A-A-59126/10	AA59126/100H02
1125-46M-0511	MIL-T-55155/10	M55155/101H02 (SE101D02S)	A-A-59126/10	AA59126/101H02
1125-46M-0512	MIL-T-55155/10	M55155/102H02 (SE102D02S)	A-A-59126/10	AA59126/102H02
1125-46M-0513	MIL-T-55155/10	M55155/103H02 (SE103D02S)	A-A-59126/10	AA59126/103H02
1125-46M-0514	MIL-T-55155/10	M55155/104H02 (SE104D02S)	A-A-59126/10	AA59126/104H02
1125-46M-0515	MIL-T-55155/10	M55155/105H02 (SE105D02S)	A-A-59126/10	AA59126/105H02
1125-46M-0516	MIL-T-55155/10	M55155/106H02 (SE106D02S)	A-A-59126/10	AA59126/106H02
1125-46M-0517	MIL-T-55155/10	M55155/107H02 (SE107D02S)	A-A-59126/10	AA59126/107H02
1125-46M-0518	MIL-T-55155/10	M55155/108H02 (SE108D02S)	A-A-59126/10	AA59126/108H02
1125-46M-0519	MIL-T-55155/10	M55155/109H02 (SE109D02S)	A-A-59126/10	AA59126/109H02

1125-46M-088XX

PART NUMBER	MIL SPECIFICATION	MIL PART NUMBER	COMMERCIAL ITEM DESCRIPTION (CID) SPECIFICATION	CID PART NUMBER
1125-46M-08810	MIL-T-55155/10	M55155/100J02	A-A-59126/10	AA59126/100J02 (AA59126/10002)
1125-46M-08811	MIL-T-55155/10	M55155/101J02	A-A-59126/10	AA59126/101J02 (AA59126/10102)
1125-46M-08812	MIL-T-55155/10	M55155/102J02	A-A-59126/10	AA59126/102J02 (AA59126/10202)
1125-46M-08813	MIL-T-55155/10	M55155/103J02	A-A-59126/10	AA59126/103J02 (AA59126/10302)
1125-46M-08814	MIL-T-55155/10	M55155/104J02	A-A-59126/10	AA59126/104J02 (AA59126/10402)

Continued on next page...

MILITARY REFERENCE SPECIFICATIONS CONTINUED:

1125-46M-088XX

PART NUMBER	MIL SPECIFICATION	MIL PART NUMBER	COMMERCIAL ITEM DESCRIPTION (CID) SPECIFICATION	CID PART NUMBER
1125-46M-08815	MIL-T-55155/10	M55155/105J02	A-A-59126/10	AA59126/105J02 (AA59126/10502)
1125-46M-08816	MIL-T-55155/10	M55155/106J02	A-A-59126/10	AA59126/106J02 (AA59126/10602)
1125-46M-08817	MIL-T-55155/10	M55155/107J02	A-A-59126/10	AA59126/107J02 (AA59126/10702)
1125-46M-08818	MIL-T-55155/10	M55155/108J02	A-A-59126/10	AA59126/108J02 (AA59126/10802)
1125-46M-08819	MIL-T-55155/10	M55155/109J02	A-A-59126/10	AA59126/109J02 (AA59126/10902)

1125-46M-095XX

PART NUMBER	MIL SPECIFICATION	MIL PART NUMBER	COMMERCIAL ITEM DESCRIPTION (CID) SPECIFICATION	CID PART NUMBER
1125-46M-09510	MIL-T-55155/10	M55155/100I02	A-A-59126/10	AA59126/100I02
1125-46M-09511	MIL-T-55155/10	M55155/101I02	A-A-59126/10	AA59126/101I02
1125-46M-09512	MIL-T-55155/10	M55155/102I02	A-A-59126/10	AA59126/102I02
1125-46M-09513	MIL-T-55155/10	M55155/103I02	A-A-59126/10	AA59126/103I02
1125-46M-09514	MIL-T-55155/10	M55155/104I02	A-A-59126/10	AA59126/104I02
1125-46M-09515	MIL-T-55155/10	M55155/105I02	A-A-59126/10	AA59126/105I02
1125-46M-09516	MIL-T-55155/10	M55155/106I02	A-A-59126/10	AA59126/106I02
1125-46M-09517	MIL-T-55155/10	M55155/107I02	A-A-59126/10	AA59126/107I02
1125-46M-09518	MIL-T-55155/10	M55155/108I02	A-A-59126/10	AA59126/108I02
1125-46M-09519	MIL-T-55155/10	M55155/109I02	A-A-59126/10	AA59126/109I02

TOOLING:

INSTALLATION TOOL: ARBOR PRESS	INSTALLATION TOOL: ANVIL (ARBOR PRESS OPERATED)	INSTALLATION TOOL: PRESS-FIT / ROLL SWAGE / RIVET PUNCH (ARBOR PRESS OPERATED)	INSTALLATION TOOL: PRESS-FIT (HAND OPERATED)
N/A	N/A	N/A	N/A

NOTES:

DATASHEET NOTES

SCREW IS NOT INCLUDED.

INSTRUCTION NOTES

N/A