

| | |
|------------------------|---------------------------------------|
| DRAWING NUMBER: | 1125-46M-XXXXZ |
| PRODUCT GROUP: | TERMINALS |
| SUB-GROUP: | MILITARY INSULATED TERMINALS |
| DESCRIPTION: | PTFE INSULATED DOUBLE TURRET TERMINAL |

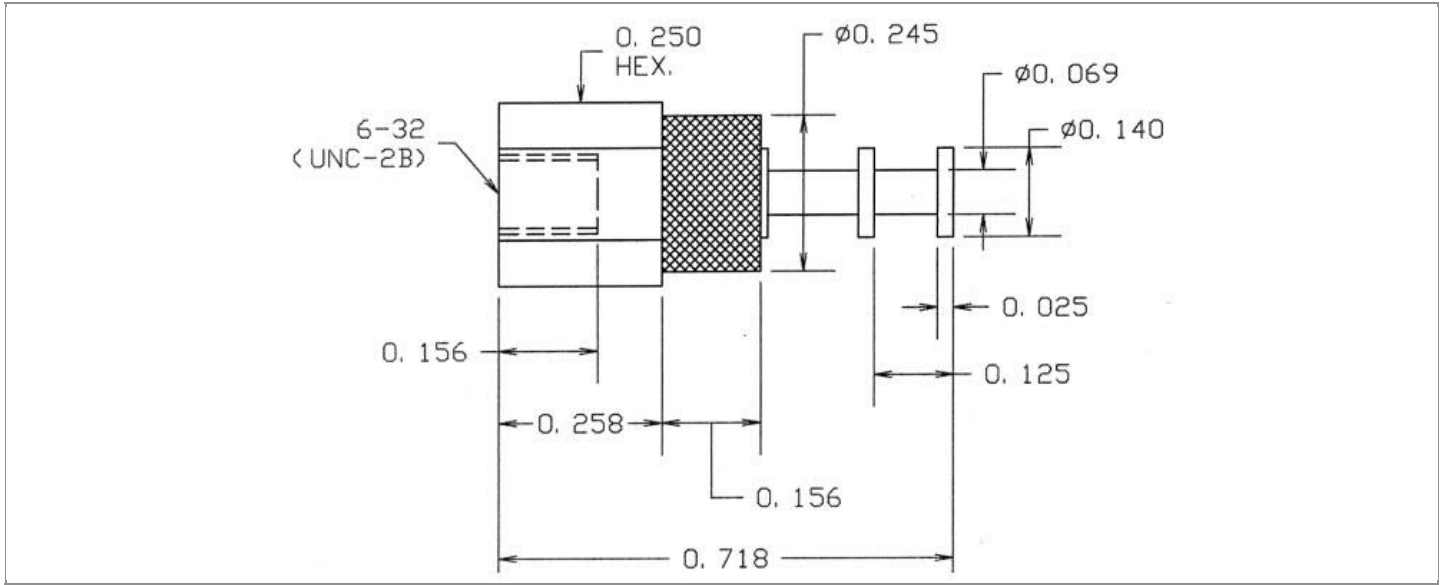

| PIN DIAMETER | OVERALL LENGTH | MOUNTING ORIENTATION | BOARD / PANEL MOUNTING METHOD |
|-------------------------|------------------------|----------------------|-------------------------------|
| N/A | 0.718" | VERTICAL | THREAD MOUNT (6-32 SCREW) |
| BOARD / PANEL THICKNESS | MOUNTING HOLE SIZE | DRILL SIZE | FEED THRU COMBINATION |
| N/A | CLEARANCE FOR SCREW #6 | #27 | N/A |

PART NO. STRUCTURE:*

| | | | | | |
|-------------|---|-----------|---|--------|------------------|
| 1125 | - | 46M | - | XX | XX |
| PART SERIES | | DIMENSION | | FINISH | INSULATION COLOR |

*If applicable, "Z" at the end of a PART NO. STRUCTURE indicates TERMINAL MATERIAL TYPE.

MATERIAL OPTIONS:

1125-46M-XXXXZ

| COMPONENT | MATERIAL | MATERIAL AND SPECIFICATION |
|-------------------|-----------------|---|
| TERMINAL | PHOSPHOR BRONZE | PHOSPHOR BRONZE PER ASTM B139, ALLOY C54400 |
| BASE/METAL SLEEVE | BRASS | BRASS PER ASTM B16, ALLOY C36000, 1/2 HARD |
| INSULATION* | PTFE | PTFE PER ASTM D1710 |
| NUT | N/A | N/A |
| WASHER | N/A | N/A |

*For Insulation color, please see INSULATION COLOR OPTIONS on Page 2

FINISH - PLATING OPTIONS:

1125-46M-XXXXZ

| FINISH CODE | COMPONENT | FINISH | FINISH AND SPECIFICATION |
|-------------|-------------------|-----------------|---|
| 05 | TERMINAL | ELECTRO-SOLDER | 0.000300"MIN. ELECTRO-SOLDER PER SAE-AMS-P-81728 OVER 0.000100"MIN. COPPER PER SAE-AMS-2418 |
| | BASE/METAL SLEEVE | ELECTRO-SOLDER | 0.000100"MIN. ELECTRO-SOLDER PER SAE-AMS-P-81728 OVER 0.000100"MIN. NICKEL PER SAE-AMS-QQ-N-290 |
| | NUT | N/A | N/A |
| | WASHER | N/A | N/A |
| 088 | TERMINAL | BRIGHT TIN-LEAD | 0.000300"MIN. BRIGHT TIN-LEAD (Sn93%-Pb7%) PER ASTM B545 OVER 0.000100"MIN. COPPER PER SAE-AMS-2418 |
| | BASE/METAL SLEEVE | BRIGHT TIN-LEAD | 0.000100"MIN. BRIGHT TIN-LEAD (Sn93%-Pb7%) PER ASTM B545 OVER 0.000100"MIN. NICKEL PER SAE-AMS-QQ-N-290 |
| | NUT | N/A | N/A |
| | WASHER | N/A | N/A |
| 095 | TERMINAL | HOT SOLDER DIP | 0.000100"MIN. HOT SOLDER DIP USING Sn60 PER IPC-J-STD-006 OVER 0.000100"MIN. COPPER PER SAE-AMS-2418 |
| | BASE/METAL SLEEVE | BRIGHT TIN-LEAD | 0.000100"MIN. BRIGHT TIN-LEAD (Sn93%-Pb7%) PER ASTM B545 OVER 0.000100"MIN. NICKEL PER SAE-AMS-QQ-N-290 |
| | NUT | N/A | N/A |
| | WASHER | N/A | N/A |

INSULATION COLOR OPTIONS:

1125-46M-XXXXZ

| INSULATION COLOR | BLACK | BLUE | BROWN | GRAY | GREEN | ORANGE | RED | VIOLET | WHITE | YELLOW |
|------------------|-------|------|-------|------|-------|--------|-----|--------|-------|--------|
| COLOR CODE NO. | 10 | 16 | 11 | 18 | 15 | 13 | 12 | 17 | 19 | 14 |

TOLERANCES:*

| DECIMAL | FRACTIONAL | ANGULAR | DRAWING ORIGATION DATE | LAST MODIFICATION DATE |
|---------|------------|---------|------------------------|------------------------|
| ± 0.015 | N/A | N/A | 8/6/1998 | 3/1/2017 |

*All dimensions are in inches.

RoHS COMPLIANCE:

1125-46M-05XXZ

| PART NUMBER | RoHS COMPLIANT |
|----------------|----------------|
| 1125-46M-0510Z | NO |
| 1125-46M-0511Z | NO |
| 1125-46M-0512Z | NO |
| 1125-46M-0513Z | NO |
| 1125-46M-0514Z | NO |
| 1125-46M-0515Z | NO |
| 1125-46M-0516Z | NO |
| 1125-46M-0517Z | NO |
| 1125-46M-0518Z | NO |
| 1125-46M-0519Z | NO |

1125-46M-088XXZ

| PART NUMBER | RoHS COMPLIANT |
|-----------------|----------------|
| 1125-46M-08810Z | NO |
| 1125-46M-08811Z | NO |
| 1125-46M-08812Z | NO |
| 1125-46M-08813Z | NO |
| 1125-46M-08814Z | NO |
| 1125-46M-08815Z | NO |
| 1125-46M-08816Z | NO |
| 1125-46M-08817Z | NO |
| 1125-46M-08818Z | NO |
| 1125-46M-08819Z | NO |

1125-46M-095XXZ

| PART NUMBER | RoHS COMPLIANT |
|-----------------|----------------|
| 1125-46M-09510Z | NO |
| 1125-46M-09511Z | NO |
| 1125-46M-09512Z | NO |
| 1125-46M-09513Z | NO |
| 1125-46M-09514Z | NO |
| 1125-46M-09515Z | NO |
| 1125-46M-09516Z | NO |
| 1125-46M-09517Z | NO |
| 1125-46M-09518Z | NO |
| 1125-46M-09519Z | NO |

MILITARY REFERENCE SPECIFICATIONS:

1125-46M-05XXZ

| PART NUMBER | MIL SPECIFICATION | MIL PART NUMBER | COMMERCIAL ITEM DESCRIPTION (CID) SPECIFICATION | CID PART NUMBER |
|----------------|-------------------|---------------------------|---|-----------------|
| 1125-46M-0510Z | MIL-T-55155/10 | M55155/100B02 (SE100D02Z) | A-A-59126/10 | AA59126/100B02 |
| 1125-46M-0511Z | MIL-T-55155/10 | M55155/101B02 (SE101D02Z) | A-A-59126/10 | AA59126/101B02 |
| 1125-46M-0512Z | MIL-T-55155/10 | M55155/102B02 (SE102D02Z) | A-A-59126/10 | AA59126/102B02 |
| 1125-46M-0513Z | MIL-T-55155/10 | M55155/103B02 (SE103D02Z) | A-A-59126/10 | AA59126/103B02 |
| 1125-46M-0514Z | MIL-T-55155/10 | M55155/104B02 (SE104D02Z) | A-A-59126/10 | AA59126/104B02 |
| 1125-46M-0515Z | MIL-T-55155/10 | M55155/105B02 (SE105D02Z) | A-A-59126/10 | AA59126/105B02 |
| 1125-46M-0516Z | MIL-T-55155/10 | M55155/106B02 (SE106D02Z) | A-A-59126/10 | AA59126/106B02 |
| 1125-46M-0517Z | MIL-T-55155/10 | M55155/107B02 (SE107D02Z) | A-A-59126/10 | AA59126/107B02 |
| 1125-46M-0518Z | MIL-T-55155/10 | M55155/108B02 (SE108D02Z) | A-A-59126/10 | AA59126/108B02 |
| 1125-46M-0519Z | MIL-T-55155/10 | M55155/109B02 (SE109D02Z) | A-A-59126/10 | AA59126/109B02 |

1125-46M-088XXZ

| PART NUMBER | MIL SPECIFICATION | MIL PART NUMBER | COMMERCIAL ITEM DESCRIPTION (CID) SPECIFICATION | CID PART NUMBER |
|-----------------|-------------------|-----------------|---|-----------------|
| 1125-46M-08810Z | MIL-T-55155/10 | M55155/100D02 | A-A-59126/10 | AA59126/100D02 |
| 1125-46M-08811Z | MIL-T-55155/10 | M55155/101D02 | A-A-59126/10 | AA59126/101D02 |
| 1125-46M-08812Z | MIL-T-55155/10 | M55155/102D02 | A-A-59126/10 | AA59126/102D02 |
| 1125-46M-08813Z | MIL-T-55155/10 | M55155/103D02 | A-A-59126/10 | AA59126/103D02 |
| 1125-46M-08814Z | MIL-T-55155/10 | M55155/104D02 | A-A-59126/10 | AA59126/104D02 |

Continued on next page...

MILITARY REFERENCE SPECIFICATIONS CONTINUED:

1125-46M-088XXZ

| PART NUMBER | MIL SPECIFICATION | MIL PART NUMBER | COMMERCIAL ITEM DESCRIPTION (CID) SPECIFICATION | CID PART NUMBER |
|-----------------|-------------------|-----------------|---|-----------------|
| 1125-46M-08815Z | MIL-T-55155/10 | M55155/105D02 | A-A-59126/10 | AA59126/105D02 |
| 1125-46M-08816Z | MIL-T-55155/10 | M55155/106D02 | A-A-59126/10 | AA59126/106D02 |
| 1125-46M-08817Z | MIL-T-55155/10 | M55155/107D02 | A-A-59126/10 | AA59126/107D02 |
| 1125-46M-08818Z | MIL-T-55155/10 | M55155/108D02 | A-A-59126/10 | AA59126/108D02 |
| 1125-46M-08819Z | MIL-T-55155/10 | M55155/109D02 | A-A-59126/10 | AA59126/109D02 |

1125-46M-095XXZ

| PART NUMBER | MIL SPECIFICATION | MIL PART NUMBER | COMMERCIAL ITEM DESCRIPTION (CID) SPECIFICATION | CID PART NUMBER |
|-----------------|-------------------|-----------------|---|-----------------|
| 1125-46M-09510Z | MIL-T-55155/10 | M55155/100C02 | A-A-59126/10 | AA59126/100C02 |
| 1125-46M-09511Z | MIL-T-55155/10 | M55155/101C02 | A-A-59126/10 | AA59126/101C02 |
| 1125-46M-09512Z | MIL-T-55155/10 | M55155/102C02 | A-A-59126/10 | AA59126/102C02 |
| 1125-46M-09513Z | MIL-T-55155/10 | M55155/103C02 | A-A-59126/10 | AA59126/103C02 |
| 1125-46M-09514Z | MIL-T-55155/10 | M55155/104C02 | A-A-59126/10 | AA59126/104C02 |
| 1125-46M-09515Z | MIL-T-55155/10 | M55155/105C02 | A-A-59126/10 | AA59126/105C02 |
| 1125-46M-09516Z | MIL-T-55155/10 | M55155/106C02 | A-A-59126/10 | AA59126/106C02 |
| 1125-46M-09517Z | MIL-T-55155/10 | M55155/107C02 | A-A-59126/10 | AA59126/107C02 |
| 1125-46M-09518Z | MIL-T-55155/10 | M55155/108C02 | A-A-59126/10 | AA59126/108C02 |
| 1125-46M-09519Z | MIL-T-55155/10 | M55155/109C02 | A-A-59126/10 | AA59126/109C02 |

TOOLING:

| INSTALLATION TOOL: ARBOR PRESS | INSTALLATION TOOL: ANVIL (ARBOR PRESS OPERATED) | INSTALLATION TOOL: PRESS-FIT / ROLL SWAGE / RIVET PUNCH (ARBOR PRESS OPERATED) | INSTALLATION TOOL: PRESS-FIT (HAND OPERATED) |
|-----------------------------------|---|--|--|
| N/A | N/A | N/A | N/A |

NOTES:

| |
|--------------------------|
| DATASHEET NOTES |
| SCREW IS NOT INCLUDED. |
| INSTRUCTION NOTES |
| N/A |