

DRAWING NUMBER:	1125-45M-XXXX
PRODUCT GROUP:	TERMINALS
SUB-GROUP:	MILITARY INSULATED TERMINALS
DESCRIPTION:	PTFE INSULATED DOUBLE TURRET TERMINAL

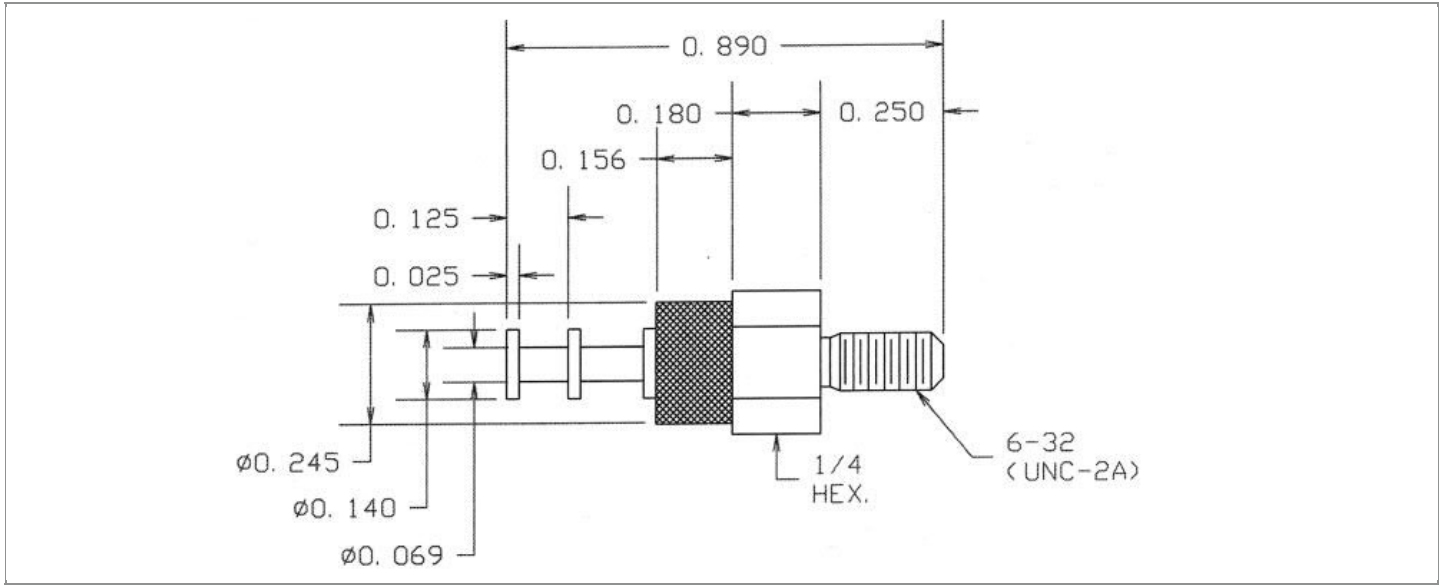

PIN DIAMETER	OVERALL LENGTH	MOUNTING ORIENTATION	BOARD / PANEL MOUNTING METHOD
N/A	0.890"	VERTICAL	THREAD MOUNT (6-32 NUT)
BOARD / PANEL THICKNESS	MOUNTING HOLE SIZE	DRILL SIZE	FEED THRU COMBINATION
UP TO 1/8"	0.144" ± 0.002	#27	N/A

PART NO. STRUCTURE:*

1125	-	45M	-	XX	XX
PART SERIES		DIMENSION		FINISH	INSULATION COLOR

*If applicable, "Z" at the end of a PART NO. STRUCTURE indicates TERMINAL MATERIAL TYPE.

MATERIAL OPTIONS:

1125-45M-XXXX

COMPONENT	MATERIAL	MATERIAL AND SPECIFICATION
TERMINAL	BRASS	BRASS PER ASTM B16, ALLOY C36000, 1/2 HARD
BASE/METAL SLEEVE	BRASS	BRASS PER ASTM B16, ALLOY C36000, 1/2 HARD
INSULATION*	PTFE	PTFE PER ASTM D1710
NUT	BRASS	BRASS PER ASTM B16, ALLOY C36000, 1/2 HARD
WASHER	PHOSPHOR BRONZE	PHOSPHOR BRONZE PER MS35333

*For Insulation color, please see INSULATION COLOR OPTIONS on Page 2

FINISH - PLATING OPTIONS:

1125-45M-XXXX

FINISH CODE	COMPONENT	FINISH	FINISH AND SPECIFICATION
05	TERMINAL	ELECTRO-SOLDER	0.000300"MIN. ELECTRO-SOLDER PER SAE-AMS-P-81728 OVER 0.000100"MIN. COPPER PER SAE-AMS-2418
	BASE/METAL SLEEVE	ELECTRO-SOLDER	0.000100"MIN. ELECTRO-SOLDER PER SAE-AMS-P-81728 OVER 0.000100"MIN. NICKEL PER SAE-AMS-QQ-N-290
	NUT	NICKEL	0.000100"MIN. NICKEL PER SAE-AMS-QQ-N-290
	WASHER	NICKEL	0.000100"MIN. NICKEL PER SAE-AMS-QQ-N-290
088	TERMINAL	BRIGHT TIN-LEAD	0.000300"MIN. BRIGHT TIN-LEAD (Sn93%-Pb7%) PER ASTM B545 OVER 0.000100"MIN. COPPER PER SAE-AMS-2418
	BASE/METAL SLEEVE	BRIGHT TIN-LEAD	0.000100"MIN. BRIGHT TIN-LEAD (Sn93%-Pb7%) PER ASTM B545 OVER 0.000100"MIN. NICKEL PER SAE-AMS-QQ-N-290
	NUT	NICKEL	0.000100"MIN. NICKEL PER SAE-AMS-QQ-N-290
	WASHER	NICKEL	0.000100"MIN. NICKEL PER SAE-AMS-QQ-N-290
095	TERMINAL	HOT SOLDER DIP	0.000100"MIN. HOT SOLDER DIP USING Sn60 PER IPC-J-STD-006 OVER 0.000100"MIN. COPPER PER SAE-AMS-2418
	BASE/METAL SLEEVE	BRIGHT TIN-LEAD	0.000100"MIN. BRIGHT TIN-LEAD (Sn93%-Pb7%) PER ASTM B545 OVER 0.000100"MIN. NICKEL PER SAE-AMS-QQ-N-290
	NUT	NICKEL	0.000100"MIN. NICKEL PER SAE-AMS-QQ-N-290
	WASHER	NICKEL	0.000100"MIN. NICKEL PER SAE-AMS-QQ-N-290

INSULATION COLOR OPTIONS:

1125-45M-XXXX

INSULATION COLOR	BLACK	BLUE	BROWN	GRAY	GREEN	ORANGE	RED	VIOLET	WHITE	YELLOW
COLOR CODE NO.	10	16	11	18	15	13	12	17	19	14

TOLERANCES:*

DECIMAL	FRACTIONAL	ANGULAR	DRAWING ORIGATION DATE	LAST MODIFICATION DATE
± 0.015	N/A	N/A	7/15/1998	3/1/2017

*All dimensions are in inches.

RoHS COMPLIANCE:

1125-45M-05XX

PART NUMBER	RoHS COMPLIANT
1125-45M-0510	NO
1125-45M-0511	NO
1125-45M-0512	NO
1125-45M-0513	NO
1125-45M-0514	NO
1125-45M-0515	NO
1125-45M-0516	NO
1125-45M-0517	NO
1125-45M-0518	NO
1125-45M-0519	NO

1125-45M-088XX

PART NUMBER	RoHS COMPLIANT
1125-45M-08810	NO
1125-45M-08811	NO
1125-45M-08812	NO
1125-45M-08813	NO
1125-45M-08814	NO
1125-45M-08815	NO
1125-45M-08816	NO
1125-45M-08817	NO
1125-45M-08818	NO
1125-45M-08819	NO

1125-45M-095XX

PART NUMBER	RoHS COMPLIANT
1125-45M-09510	NO
1125-45M-09511	NO
1125-45M-09512	NO
1125-45M-09513	NO
1125-45M-09514	NO
1125-45M-09515	NO
1125-45M-09516	NO
1125-45M-09517	NO
1125-45M-09518	NO
1125-45M-09519	NO

MILITARY REFERENCE SPECIFICATIONS:

1125-45M-05XX

PART NUMBER	MIL SPECIFICATION	MIL PART NUMBER	COMMERCIAL ITEM DESCRIPTION (CID) SPECIFICATION	CID PART NUMBER
1125-45M-0510	MIL-T-55155/09	M55155/090H02 (SE090E02S)	A-A-59126/09	AA59126/090H02
1125-45M-0511	MIL-T-55155/09	M55155/091H02 (SE091E02S)	A-A-59126/09	AA59126/091H02
1125-45M-0512	MIL-T-55155/09	M55155/092H02 (SE092E02S)	A-A-59126/09	AA59126/092H02
1125-45M-0513	MIL-T-55155/09	M55155/093H02 (SE093E02S)	A-A-59126/09	AA59126/093H02
1125-45M-0514	MIL-T-55155/09	M55155/094H02 (SE094E02S)	A-A-59126/09	AA59126/094H02
1125-45M-0515	MIL-T-55155/09	M55155/095H02 (SE095E02S)	A-A-59126/09	AA59126/095H02
1125-45M-0516	MIL-T-55155/09	M55155/096H02 (SE096E02S)	A-A-59126/09	AA59126/096H02
1125-45M-0517	MIL-T-55155/09	M55155/097H02 (SE097E02S)	A-A-59126/09	AA59126/097H02
1125-45M-0518	MIL-T-55155/09	M55155/098H02 (SE098E02S)	A-A-59126/09	AA59126/098H02
1125-45M-0519	MIL-T-55155/09	M55155/099H02 (SE099E02S)	A-A-59126/09	AA59126/099H02

1125-45M-088XX

PART NUMBER	MIL SPECIFICATION	MIL PART NUMBER	COMMERCIAL ITEM DESCRIPTION (CID) SPECIFICATION	CID PART NUMBER
1125-45M-08810	MIL-T-55155/09	M55155/090J02	A-A-59126/09	AA59126/090J02 (AA59126/09002)
1125-45M-08811	MIL-T-55155/09	M55155/091J02	A-A-59126/09	AA59126/091J02 (AA59126/09102)
1125-45M-08812	MIL-T-55155/09	M55155/092J02	A-A-59126/09	AA59126/092J02 (AA59126/09202)
1125-45M-08813	MIL-T-55155/09	M55155/093J02	A-A-59126/09	AA59126/093J02 (AA59126/09302)
1125-45M-08814	MIL-T-55155/09	M55155/094J02	A-A-59126/09	AA59126/094J02 (AA59126/09402)

Continued on next page...

MILITARY REFERENCE SPECIFICATIONS CONTINUED:

1125-45M-088XX

PART NUMBER	MIL SPECIFICATION	MIL PART NUMBER	COMMERCIAL ITEM DESCRIPTION (CID) SPECIFICATION	CID PART NUMBER
1125-45M-08815	MIL-T-55155/09	M55155/095J02	A-A-59126/09	AA59126/095J02 (AA59126/09502)
1125-45M-08816	MIL-T-55155/09	M55155/096J02	A-A-59126/09	AA59126/096J02 (AA59126/09602)
1125-45M-08817	MIL-T-55155/09	M55155/097J02	A-A-59126/09	AA59126/097J02 (AA59126/09702)
1125-45M-08818	MIL-T-55155/09	M55155/098J02	A-A-59126/09	AA59126/098J02 (AA59126/09802)
1125-45M-08819	MIL-T-55155/09	M55155/099J02	A-A-59126/09	AA59126/099J02 (AA59126/09902)

1125-45M-095XX

PART NUMBER	MIL SPECIFICATION	MIL PART NUMBER	COMMERCIAL ITEM DESCRIPTION (CID) SPECIFICATION	CID PART NUMBER
1125-45M-09510	MIL-T-55155/09	M55155/090I02	A-A-59126/09	AA59126/090I02
1125-45M-09511	MIL-T-55155/09	M55155/091I02	A-A-59126/09	AA59126/091I02
1125-45M-09512	MIL-T-55155/09	M55155/092I02	A-A-59126/09	AA59126/092I02
1125-45M-09513	MIL-T-55155/09	M55155/093I02	A-A-59126/09	AA59126/093I02
1125-45M-09514	MIL-T-55155/09	M55155/094I02	A-A-59126/09	AA59126/094I02
1125-45M-09515	MIL-T-55155/09	M55155/095I02	A-A-59126/09	AA59126/095I02
1125-45M-09516	MIL-T-55155/09	M55155/096I02	A-A-59126/09	AA59126/096I02
1125-45M-09517	MIL-T-55155/09	M55155/097I02	A-A-59126/09	AA59126/097I02
1125-45M-09518	MIL-T-55155/09	M55155/098I02	A-A-59126/09	AA59126/098I02
1125-45M-09519	MIL-T-55155/09	M55155/099I02	A-A-59126/09	AA59126/099I02

TOOLING:

INSTALLATION TOOL: ARBOR PRESS	INSTALLATION TOOL: ANVIL (ARBOR PRESS OPERATED)	INSTALLATION TOOL: PRESS-FIT / ROLL SWAGE / RIVET PUNCH (ARBOR PRESS OPERATED)	INSTALLATION TOOL: PRESS-FIT (HAND OPERATED)
N/A	N/A	N/A	N/A

NOTES:

DATASHEET NOTES

NUT PART NO.: 701-7320-02, WASHER PART NO.: 701-7722-02.

INSTRUCTION NOTES

SUPPLIED WITH NICKEL PLATED BRASS HEX NUT (6-32 x 5/16" x 7/64") AND NICKEL PLATED PHOSPHOR BRONZE #6 INTERNAL TOOTH LOCKWASHER.