

<b>DRAWING NUMBER:</b>	<b>15R-142-X-XX</b>
<b>PRODUCT GROUP:</b>	TERMINALS
<b>SUB-GROUP:</b>	MILITARY NON-INSULATED TERMINALS
<b>DESCRIPTION:</b>	NON-INSULATED TURRET TERMINAL

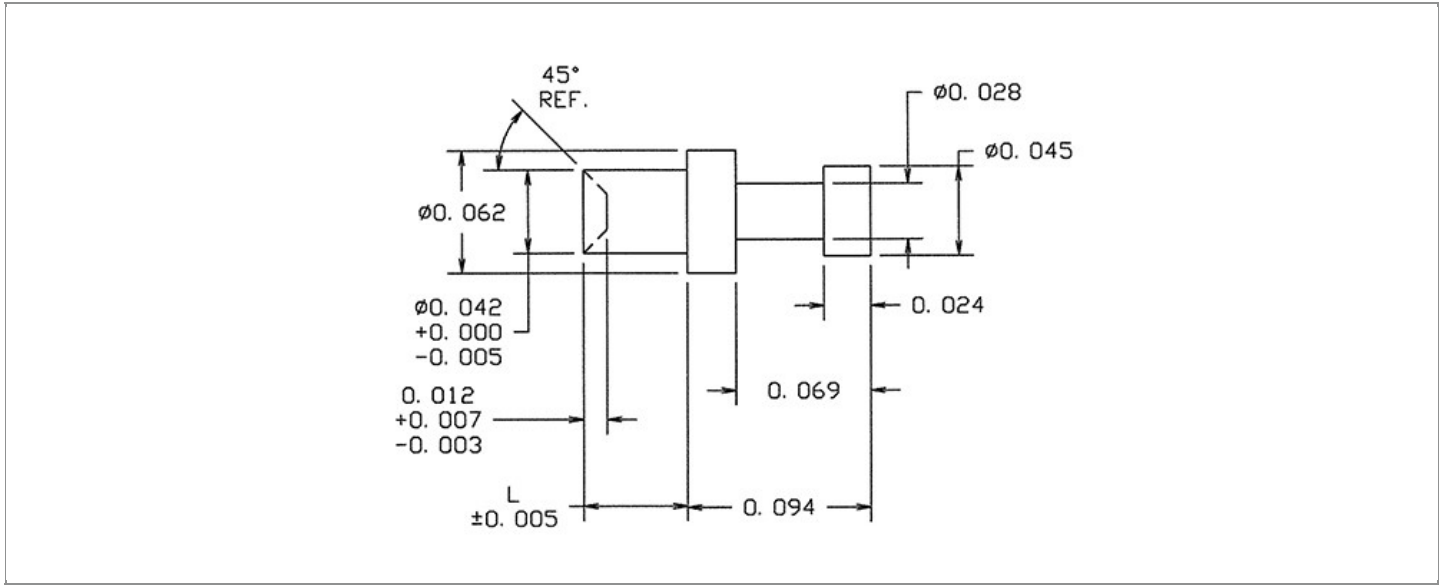

BOARD / PANEL MOUNTING METHOD	MOUNTING HOLE SIZE	DRILL SIZE	FEED THRU COMBINATION
SWAGE MOUNT	0.043" ± 0.001	#57	N/A

**PART NO. STRUCTURE:**

15R-142 - X - XX  
PART SERIES    DIMENSION    FINISH

**MATERIAL OPTIONS:**

15R-142-X-XX

COMPONENT	MATERIAL	MATERIAL AND SPECIFICATION
TERMINAL	PHOSPHOR BRONZE	PHOSPHOR BRONZE PER ASTM B139, ALLOY C54400

**DIMENSION OPTIONS:**

15R-142-X-XX

DIMENSION	K	OVERALL LENGTH	SHANK LENGTH (L)	BOARD/PANEL THICKNESS
1	N/A	0.147"	0.053"	1/32"
2	N/A	0.178"	0.084"	1/16"
11	N/A	0.131"	0.037"	1/64"

FINISH - PLATING OPTIONS:

15R-142-X-**XX**

FINISH CODE	COMPONENT	FINISH	FINISH AND SPECIFICATION
05	TERMINAL	ELECTRO-SOLDER	0.000300"MIN. ELECTRO-SOLDER PER SAE-AMS-P-81728 OVER 0.000100"MIN. COPPER PER SAE-AMS-2418
088	TERMINAL	BRIGHT TIN-LEAD	0.000300"MIN. BRIGHT TIN-LEAD (Sn93%-Pb7%) PER ASTM B545 OVER 0.000100"MIN. COPPER PER SAE-AMS-2418
095	TERMINAL	HOT SOLDER DIP	0.000100"MIN. HOT SOLDER DIP USING Sn60 PER IPC-J-STD-006 OVER 0.000100"MIN. COPPER PER SAE-AMS-2418

TOLERANCES:\*

DECIMAL	FRACTIONAL	ANGULAR	DRAWING ORIGATION DATE	LAST MODIFICATION DATE
± 0.005	N/A	± 3 °	10/22/2002	3/1/2017

\*All dimensions are in inches.

RoHS COMPLIANCE:

15R-142-1-XX

PART NUMBER	RoHS COMPLIANT
15R-142-1-05	NO
15R-142-1-088	NO
15R-142-1-095	NO

15R-142-2-XX

PART NUMBER	RoHS COMPLIANT
15R-142-2-05	NO
15R-142-2-088	NO
15R-142-2-095	NO

15R-142-11-XX

PART NUMBER	RoHS COMPLIANT
15R-142-11-05	NO
15R-142-11-088	NO
15R-142-11-095	NO

MILITARY REFERENCE SPECIFICATIONS:

15R-142-1-XX

PART NUMBER	MIL SPECIFICATION	MIL PART NUMBER	COMMERCIAL ITEM DESCRIPTION (CID) SPECIFICATION	CID PART NUMBER
15R-142-1-05	MIL-T-55155/11	M55155/11XB09 (M55155/11-9Z; SE11XC09Z)	A-A-59126/11	AA59126/11XB09
15R-142-1-088	MIL-T-55155/11	M55155/11XD09	A-A-59126/11	AA59126/11XD09
15R-142-1-095	MIL-T-55155/11	M55155/11XC09	A-A-59126/11	AA59126/11XC09

15R-142-2-XX

PART NUMBER	MIL SPECIFICATION	MIL PART NUMBER	COMMERCIAL ITEM DESCRIPTION (CID) SPECIFICATION	CID PART NUMBER
15R-142-2-05	MIL-T-55155/11	M55155/11XB10 (M55155/11-10Z; SE11XC10Z)	A-A-59126/11	AA59126/11XB10
15R-142-2-088	MIL-T-55155/11	M55155/11XD10	A-A-59126/11	AA59126/11XD10
15R-142-2-095	MIL-T-55155/11	M55155/11XC10	A-A-59126/11	AA59126/11XC10

Continued on next page...

MILITARY REFERENCE SPECIFICATIONS CONTINUED:

15R-142-11-XX

PART NUMBER	MIL SPECIFICATION	MIL PART NUMBER	COMMERCIAL ITEM DESCRIPTION (CID) SPECIFICATION	CID PART NUMBER
15R-142-11-05	MIL-T-55155/11	M55155/11XB08 (M55155/11-8Z; SE11XC08Z)	A-A-59126/11	AA59126/11XB08
15R-142-11-088	MIL-T-55155/11	M55155/11XD08	A-A-59126/11	AA59126/11XD08
15R-142-11-095	MIL-T-55155/11	M55155/11XC08	A-A-59126/11	AA59126/11XC08

TOOLING:

INSTALLATION TOOL: ARBOR PRESS	INSTALLATION TOOL: ANVIL (ARBOR PRESS OPERATED)	INSTALLATION TOOL: PRESS-FIT / ROLL SWAGE / RIVET PUNCH (ARBOR PRESS OPERATED)	INSTALLATION TOOL: FLARE SWAGE PUNCH (ARBOR PRESS OPERATED)
TM1	TA62-45-25	TP10-142	N/A

NOTES:

<b>DATASHEET NOTES</b>
------------------------

N/A

<b>INSTRUCTION NOTES</b>
--------------------------

SEE GENERAL SWAGING INSTALLATION INSTRUCTION ON CONCORD ELECTRONICS' WEBSITE [WWW.CONCORD-ELECTRONICS.COM](http://WWW.CONCORD-ELECTRONICS.COM)