

<b>DRAWING NUMBER:</b>	<b>15R-102-X-XX</b>
<b>PRODUCT GROUP:</b>	TERMINALS
<b>SUB-GROUP:</b>	MILITARY NON-INSULATED TERMINALS
<b>DESCRIPTION:</b>	NON-INSULATED TURRET TERMINAL

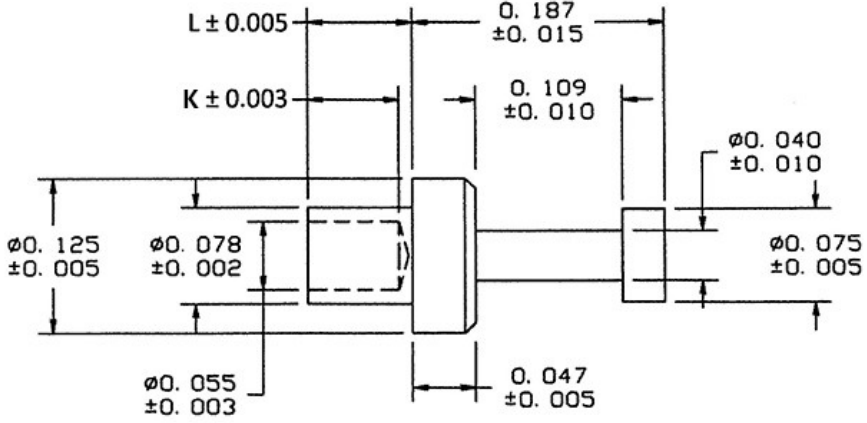

BOARD / PANEL MOUNTING METHOD	MOUNTING HOLE SIZE	DRILL SIZE	FEED THRU COMBINATION
SWAGE MOUNT	0.082" ± 0.001	#45	N/A

**PART NO. STRUCTURE:**

15R-102 - X - XX  
 PART SERIES    DIMENSION    FINISH

**MATERIAL OPTIONS:**

15R-102-X-XX

COMPONENT	MATERIAL	MATERIAL AND SPECIFICATION
TERMINAL	PHOSPHOR BRONZE	PHOSPHOR BRONZE PER ASTM B139, ALLOY C54400

**DIMENSION OPTIONS:**

15R-102-X-XX

DIMENSION	K	OVERALL LENGTH	SHANK LENGTH (L)	BOARD/PANEL THICKNESS
1	0.068"	0.265"	0.078"	1/32"
2	0.093"	0.296"	0.109"	1/16"
3	0.093"	0.327"	0.140"	3/32"
4	0.093"	0.357"	0.170"	1/8"

FINISH - PLATING OPTIONS:

15R-102-X-**XX**

FINISH CODE	COMPONENT	FINISH	FINISH AND SPECIFICATION
05	TERMINAL	ELECTRO-SOLDER	0.000300"MIN. ELECTRO-SOLDER PER SAE-AMS-P-81728 OVER 0.000100"MIN. COPPER PER SAE-AMS-2418
088	TERMINAL	BRIGHT TIN-LEAD	0.000300"MIN. BRIGHT TIN-LEAD (Sn93%-Pb7%) PER ASTM B545 OVER 0.000100"MIN. COPPER PER SAE-AMS-2418
095	TERMINAL	HOT SOLDER DIP	0.000100"MIN. HOT SOLDER DIP USING Sn60 PER IPC-J-STD-006 OVER 0.000100"MIN. COPPER PER SAE-AMS-2418

TOLERANCES:\*

DECIMAL	FRACTIONAL	ANGULAR	DRAWING ORIGATION DATE	LAST MODIFICATION DATE
N/A	N/A	N/A	4/21/1997	3/1/2017

\*All dimensions are in inches.

RoHS COMPLIANCE:

15R-102-1-XX

PART NUMBER	RoHS COMPLIANT
15R-102-1-05	NO
15R-102-1-088	NO
15R-102-1-095	NO

15R-102-2-XX

PART NUMBER	RoHS COMPLIANT
15R-102-2-05	NO
15R-102-2-088	NO
15R-102-2-095	NO

15R-102-3-XX

PART NUMBER	RoHS COMPLIANT
15R-102-3-05	NO
15R-102-3-088	NO
15R-102-3-095	NO

15R-102-4-XX

PART NUMBER	RoHS COMPLIANT
15R-102-4-05	NO
15R-102-4-088	NO
15R-102-4-095	NO

MILITARY REFERENCE SPECIFICATIONS:

15R-102-1-XX

PART NUMBER	MIL SPECIFICATION	MIL PART NUMBER	COMMERCIAL ITEM DESCRIPTION (CID) SPECIFICATION	CID PART NUMBER
15R-102-1-05	MIL-T-55155/29	M55155/29XB03 (M55155/29-3Z; SE29XC03Z)	A-A-59126/29	AA59126/29XB03
15R-102-1-088	MIL-T-55155/29	M55155/29XD03	A-A-59126/29	AA59126/29XD03
15R-102-1-095	MIL-T-55155/29	M55155/29XC03	A-A-59126/29	AA59126/29XC03

Continued on next page...

MILITARY REFERENCE SPECIFICATIONS CONTINUED:

15R-102-2-XX

PART NUMBER	MIL SPECIFICATION	MIL PART NUMBER	COMMERCIAL ITEM DESCRIPTION (CID) SPECIFICATION	CID PART NUMBER
15R-102-2-05	MIL-T-55155/29	M55155/29XB06 (M55155/29-6Z; SE29XC06Z)	A-A-59126/29	AA59126/29XB06
15R-102-2-088	MIL-T-55155/29	M55155/29XD06	A-A-59126/29	AA59126/29XD06
15R-102-2-095	MIL-T-55155/29	M55155/29XC06	A-A-59126/29	AA59126/29XC06

15R-102-3-XX

PART NUMBER	MIL SPECIFICATION	MIL PART NUMBER	COMMERCIAL ITEM DESCRIPTION (CID) SPECIFICATION	CID PART NUMBER
15R-102-3-05	MIL-T-55155/29	M55155/29XB09 (M55155/29-9Z; SE29XC09Z)	A-A-59126/29	AA59126/29XB09
15R-102-3-088	MIL-T-55155/29	M55155/29XD09	A-A-59126/29	AA59126/29XD09
15R-102-3-095	MIL-T-55155/29	M55155/29XC09	A-A-59126/29	AA59126/29XC09

15R-102-4-XX

PART NUMBER	MIL SPECIFICATION	MIL PART NUMBER	COMMERCIAL ITEM DESCRIPTION (CID) SPECIFICATION	CID PART NUMBER
15R-102-4-05	MIL-T-55155/29	M55155/29XB12 (M55155/29-12Z; SE29XC12Z)	A-A-59126/29	AA59126/29XB12
15R-102-4-088	MIL-T-55155/29	M55155/29XD12	A-A-59126/29	AA59126/29XD12
15R-102-4-095	MIL-T-55155/29	M55155/29XC12	A-A-59126/29	AA59126/29XC12

TOOLING:

INSTALLATION TOOL: ARBOR PRESS	INSTALLATION TOOL: ANVIL (ARBOR PRESS OPERATED)	INSTALLATION TOOL: PRESS-FIT / ROLL SWAGE / RIVET PUNCH (ARBOR PRESS OPERATED)	INSTALLATION TOOL: FLARE SWAGE PUNCH (ARBOR PRESS OPERATED)
TM1	TA125-77-31	TP78-55	TFLP90-175

NOTES:

<b>DATASHEET NOTES</b>
N/A
<b>INSTRUCTION NOTES</b>
SEE GENERAL SWAGING INSTALLATION INSTRUCTION ON CONCORD ELECTRONICS' WEBSITE <a href="http://WWW.CONCORD-ELECTRONICS.COM">WWW.CONCORD-ELECTRONICS.COM</a>