

| | |
|------------------------|-------------------------------------|
| DRAWING NUMBER: | 09-9016-X-XX |
| PRODUCT GROUP: | PC JACKS |
| SUB-GROUP: | NON-INSULATED PC JACKS |
| DESCRIPTION: | PC JACK - NON-INSULATED - FEED THRU |

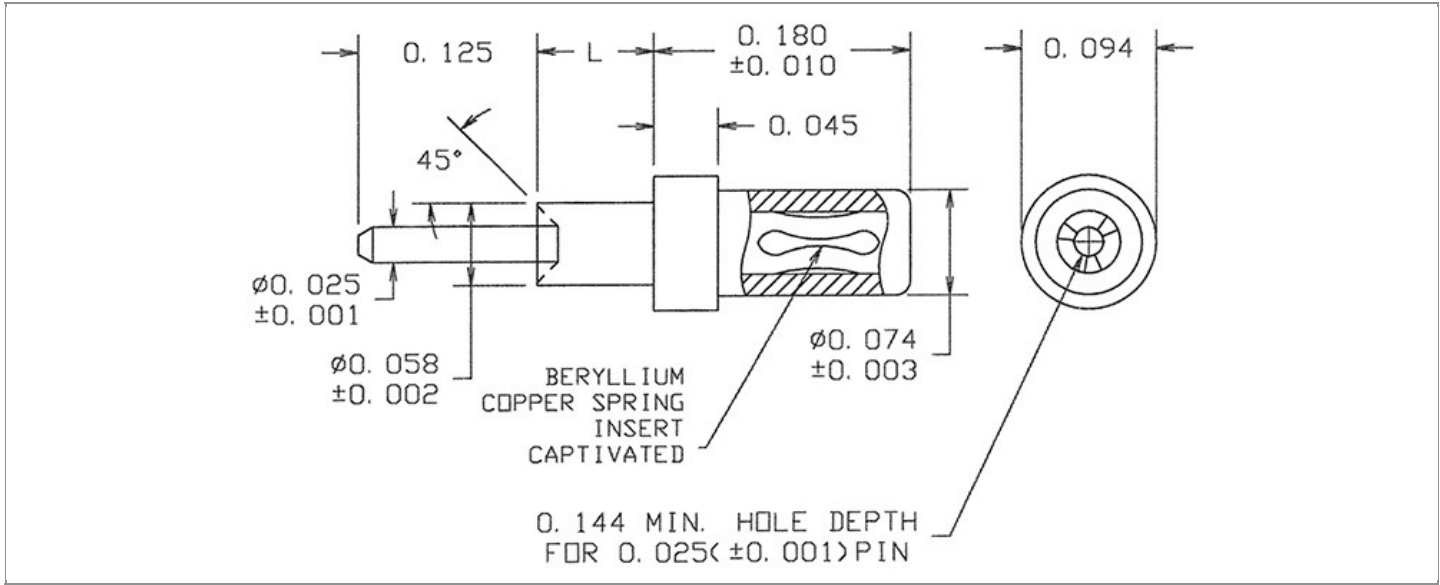

| ACCEPTS PIN / PLUG / JACK SIZE | MOUNTING ORIENTATION | BOARD / PANEL MOUNTING METHOD | MOUNTING HOLE SIZE | DRILL SIZE | FEED THRU COMBINATION |
|--------------------------------|----------------------|-------------------------------|--------------------|------------|-----------------------|
| 0.025" ± 0.001 | VERTICAL | SWAGE MOUNT | 0.062" ± 0.002 | 1/16" | JACK/PIN |

PART NO. STRUCTURE:

| | | | | |
|----------------|---|-----------|---|-----------|
| 09-9016 | - | X | - | XX |
| PART SERIES | | DIMENSION | | FINISH |

MATERIAL OPTIONS:

09-9016-X-XX

| COMPONENT | MATERIAL | MATERIAL AND SPECIFICATION |
|-------------------------|------------------|--|
| BODY | BRASS | BRASS PER ASTM B16, ALLOY C36000, 1/2 HARD |
| SPRING (CAGE) | BERYLLIUM COPPER | BERYLLIUM COPPER PER ASTM B194, ALLOY C17200 |
| MOUNTING BRACKET | N/A | N/A |

DIMENSION OPTIONS:

09-9016-X-XX

| DIMENSION | A | H | OVERALL LENGTH | MIN. HOLE DEPTH | SHANK LENGTH (L) | BOARD/PANEL THICKNESS |
|-----------|-----|-----|----------------|-----------------|------------------|-----------------------|
| 1 | N/A | N/A | 0.356" | 0.144" | 0.051" | 1/32" |
| 2 | N/A | N/A | 0.387" | 0.144" | 0.082" | 1/16" |
| 3 | N/A | N/A | 0.418" | 0.144" | 0.113" | 3/32" |
| 4 | N/A | N/A | 0.450" | 0.144" | 0.145" | 1/8" |

FINISH - PLATING OPTIONS:

09-9016-X-XX

| FINISH CODE | COMPONENT | FINISH | FINISH AND SPECIFICATION |
|-------------|------------------|--------------------|--|
| 03 | BODY | GOLD | 0.00010"MIN. GOLD PER ASTM B488, TYPE II, CODE C OVER 0.000100"MIN. NICKEL PER SAE-AMS-QQ-N-290, CLASS 2 |
| | SPRING (CAGE) | GOLD | 0.000030"MIN. GOLD PER ASTM B488, TYPE II, CODE C OVER 0.000100"MIN. NICKEL PER SAE-AMS-QQ-N-290, CLASS 2 |
| | MOUNTING BRACKET | N/A | N/A |
| 035 | BODY | GOLD | 0.000020"MIN. GOLD PER ASTM B488, TYPE II, CODE C OVER 0.000100"MIN. NICKEL PER SAE-AMS-QQ-N-290, CLASS 2 |
| | SPRING (CAGE) | GOLD | 0.000050"MIN. GOLD PER ASTM B488, TYPE II, CODE C OVER 0.000100"MIN. NICKEL PER SAE-AMS-QQ-N-290, CLASS 2 |
| | MOUNTING BRACKET | N/A | N/A |
| 04 | BODY | ELECTRO-TIN | 0.000100"MIN. ELECTRO-TIN PER ASTM B545 OVER 0.000100"MIN. NICKEL PER SAE-AMS-QQ-N-290, CLASS 2 |
| | SPRING (CAGE) | BRIGHT ELECTRO-TIN | 0.000200"MIN. BRIGHT ELECTRO-TIN PER ASTM B545 OVER 0.000050"MIN. NICKEL PER SAE-AMS-QQ-N-290, CLASS 2 |
| | MOUNTING BRACKET | N/A | N/A |
| 06 | BODY | ELECTRO-TIN | 0.000100"MIN. ELECTRO-TIN PER ASTM B545 OVER 0.000100"MIN. NICKEL PER SAE-AMS-QQ-N-290, CLASS 2 |
| | SPRING (CAGE) | GOLD | 0.000030"MIN. GOLD PER ASTM B488, TYPE II, CODE C OVER 0.000100"MIN. NICKEL PER SAE-AMS-QQ-N-290, CLASS 2 |
| | MOUNTING BRACKET | N/A | N/A |
| 063 | BODY | BRIGHT TIN-LEAD | 0.000200"MIN. BRIGHT TIN-LEAD (Sn93%-Pb7%) PER ASTM B545 OVER 0.000100"MIN. NICKEL PER SAE-AMS-QQ-N-290, CLASS 2 |
| | SPRING (CAGE) | GOLD | 0.000030"MIN. GOLD PER ASTM B488, TYPE II, CODE C OVER 0.000100"MIN. NICKEL PER SAE-AMS-QQ-N-290, CLASS 2 |
| | MOUNTING BRACKET | N/A | N/A |
| 088 | BODY | BRIGHT TIN-LEAD | 0.000200"MIN. BRIGHT TIN-LEAD (Sn93%-Pb7%) PER ASTM B545 OVER 0.000100"MIN. NICKEL PER SAE-AMS-QQ-N-290, CLASS 2 |
| | SPRING (CAGE) | BRIGHT TIN-LEAD | 0.000200"MIN. BRIGHT TIN-LEAD (Sn93%-Pb7%) PER ASTM B545 OVER 0.000100"MIN. NICKEL PER SAE-AMS-QQ-N-290, CLASS 2 |
| | MOUNTING BRACKET | N/A | N/A |

TOLERANCES:*

| DECIMAL | FRACTIONAL | ANGULAR | DRAWING ORIGATION DATE | LAST MODIFICATION DATE |
|---------|------------|---------|------------------------|------------------------|
| ± 0.005 | ± 1/64 | ± 5 ° | 05/01/01 | 01/01/17 |

*All dimensions are in inches.

RoHS COMPLIANCE:

09-9016-1-XX

| PART NUMBER | RoHS COMPLIANT |
|---------------|----------------|
| 09-9016-1-03 | YES |
| 09-9016-1-035 | YES |
| 09-9016-1-04 | YES |
| 09-9016-1-06 | YES |
| 09-9016-1-063 | NO |
| 09-9016-1-088 | NO |

09-9016-2-XX

| PART NUMBER | RoHS COMPLIANT |
|---------------|----------------|
| 09-9016-2-03 | YES |
| 09-9016-2-035 | YES |
| 09-9016-2-04 | YES |
| 09-9016-2-06 | YES |
| 09-9016-2-063 | NO |
| 09-9016-2-088 | NO |

09-9016-3-XX

| PART NUMBER | RoHS COMPLIANT |
|---------------|----------------|
| 09-9016-3-03 | YES |
| 09-9016-3-035 | YES |
| 09-9016-3-04 | YES |
| 09-9016-3-06 | YES |
| 09-9016-3-063 | NO |
| 09-9016-3-088 | NO |

09-9016-4-XX

| PART NUMBER | RoHS COMPLIANT |
|---------------|----------------|
| 09-9016-4-03 | YES |
| 09-9016-4-035 | YES |
| 09-9016-4-04 | YES |
| 09-9016-4-06 | YES |
| 09-9016-4-063 | NO |
| 09-9016-4-088 | NO |

TOOLING:

| INSTALLATION TOOL: ARBOR PRESS | INSTALLATION TOOL: ANVIL (ARBOR PRESS OPERATED) | INSTALLATION TOOL: PRESS-FIT / ROLL SWAGE / RIVET PUNCH (ARBOR PRESS OPERATED) | CRIMPING TOOL (COMMERCIAL VERSION) |
|-----------------------------------|---|---|---------------------------------------|
| TM1 | TA09-9016 | TP09-9016 | N/A |

NOTES:

| |
|---|
| DATASHEET NOTES |
| N/A |
| INSTRUCTION NOTES |
| SEE GENERAL SWAGING INSTALLATION INSTRUCTION ON CONCORD ELECTRONICS' WEBSITE WWW.CONCORD-ELECTRONICS.COM . |